

SECTION 3 CONTENTS

ALLIGATOR CLIPS62	SCREW TERMINALS	
EDGE CONNECTORS, SMT69	Slim-Line73
I-CLAMP IDC CONNECTORS72	Color Coded, THM73-77
JUMPERS		SEMS Screw76
THM60	Metric Thread77
SMT60	Swage (Panel) Mount78-79
Zero Ohm60	Binding Post79
QUICK-FIT TERMINALS		Binding Post, Mini78
Female, SMT69	SOLDER LUGS80
Female, THM68	SOLDERLESS (CRIMP) TERMINALS70-71
Headers67	TEST POINTS	
Male, Rivet Mount67	Color Coded SMT61
Male, SMT67	Color Coded THM62
Male, THM64-66	SMT61
Male, THM, Continuous Reel66	THM62
		Slotted & Loop Types (THM)63

SMT PRINTED CIRCUIT BOARD JUMPERS

AVAILABLE ON TAPE AND REEL

- Designed to link circuit board traces in applications where thru hole jumpers are not possible
- All conductive polystyrene carrier meets ANSA/EIA-481 standard
- Low profile/space saving design
- Minimal PCB footprint

MATERIAL: .020 (.51) Copper, Silver Plate

Power Rating: 0.5 Watts at 158°F (70°C), with a current of 20 Amps and a connection temperature at 221°F (105°C or less)

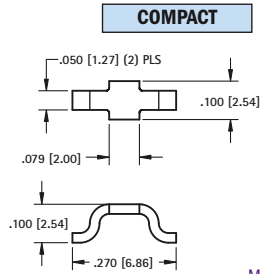
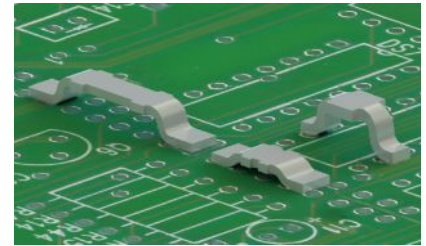

Mounting Detail

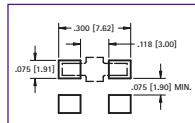

CAT. NO. 5100

CAT. NO. 5100TR - 500 pieces per reel

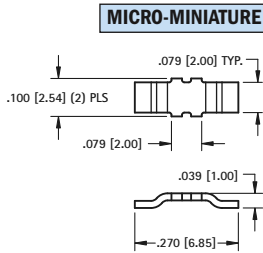

Mounting Detail

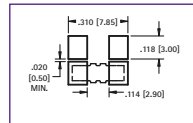

CAT. NO. 5102

CAT. NO. 5102TR - 500 pieces per reel

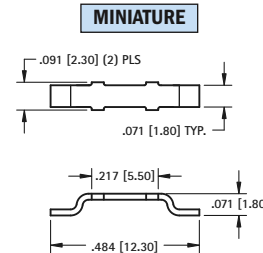

Mounting Detail

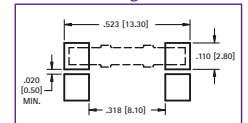

CAT. NO. 5104

CAT. NO. 5104TR - 2500 pieces per reel

HIGH CURRENT "TRUE" ZERO OHM SMT JUMPER

"True" Zero ohm high current SMT Jumpers, designed to replace Zero ohm resistors without changing board designs or layouts. These new devices are uniquely suited as true zero ohm resistor replacements.

MATERIAL: Copper, Silver Plate

Power Rating: 0.5 Watts at 158°F (70°C), with a current of 20 Amps and a connection temperature at 221°F (105°C or less)

Tape & Reel Spec's: 12mm Wide, 4mm Pitch, 1,000 pieces per 7" reel meets ANSI/EIA-481 standards

SUPPLIED ON TAPE AND REEL

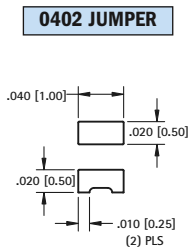

CAT. NO. 5112

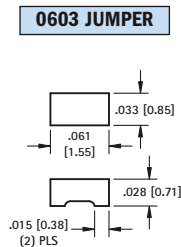

CAT. NO. 5110

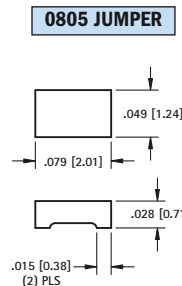

CAT. NO. 5106

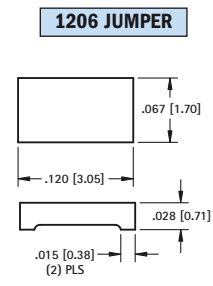

CAT. NO. 5108

THM JUMPERS

- Unique wave leg design retains jumper in thru hole for wave soldering
- May be used as a test point location

- Shorting Pin may be used in applications that require precise location of the legs
- May also be used with micro-jacks (see pages 102-103)

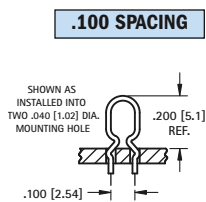

Mounting Detail

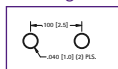

MATERIAL: .020 (.50) Dia. Phosphor Bronze, Silver Plate

CAT. NO. 5025

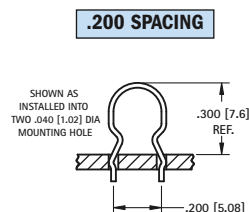

Mounting Detail

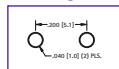

MATERIAL: .020 (.50) Dia. Phosphor Bronze, Silver Plate

CAT. NO. 5026

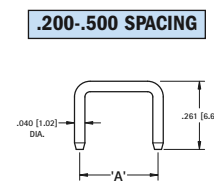

CAT. NO.	A Dim.
1430-1	.200 (5.1)
1430-2	.250 (6.4)
1430-4	.400 (10.2)
1430-5	.500 (12.7)

MATERIAL: Brass, Gold Plate

(SMT) SURFACE MOUNT TEST POINTS ON TAPE & REEL

AVAILABLE ON TAPE AND REEL

- Manufactured using flat wire to provide a large mounting surface area
- Efficient, safe, board level testing
- Simplifies testing on dense circuit boards
- Compatible with vacuum and mechanical pick & place assembly systems
- All conductive polystyrene carrier tape meets ANSA/EIA-481 standards

- Ideal for use with miniature probes, clips and hooks
- Ultra low profile, ideal for advanced surface mount PCB applications

MICRO MINIATURE

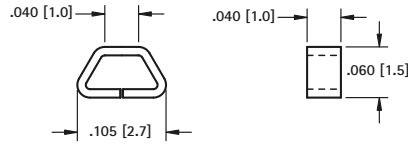

Pad Layout

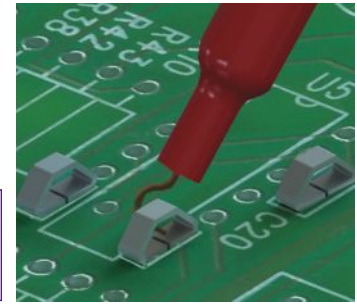
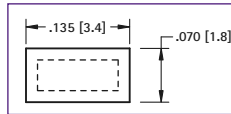

SPECIFICATIONS

Material:

.010 (.25) Phosphor Bronze, Silver Plate

CAT. NO. 5015 - 1000 pieces per reel **CAT. NO. 5017** - 5000 pieces per reel

Tape & Reel Spec's: 8mm Wide, 4mm Pitch

- Ideal for use with most standard probes, clips and hooks
- Unique design provides exceptional strength and durability

MINIATURE

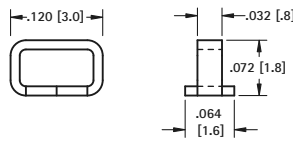

Pad Layout

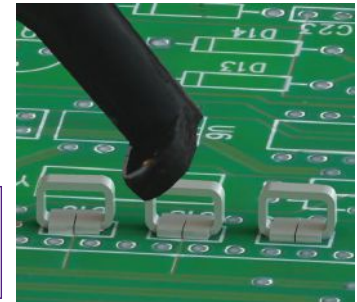
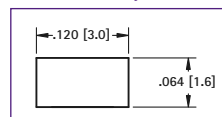

SPECIFICATIONS

Material:

.015 (.38) Phosphor Bronze, Silver Plate

CAT. NO. 5019 - 1000 pieces per reel **CAT. NO. 5029** - 5000 pieces per reel

Tape & Reel Spec's: 12mm Wide, 4mm Pitch

- Ideal for use with most standard probes, clips and hooks
- Color keyed for visibility and quick identification

COLOR KEYED

MATERIAL

Terminal: .008 (.20) Phosphor Bronze, Silver Plate

Base: LCP UL Rated 94V-0

CAT. NO.	Base Color	CAT. NO.	Base Color
5190TR	RED	5195TR	BROWN
5191TR	BLACK	5196TR	GREEN
5192TR	WHITE	5197TR	BLUE
5193TR	ORANGE	5198TR	GREY
5194TR	YELLOW	5199TR	PURPLE

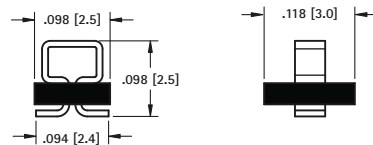

Pad Layout

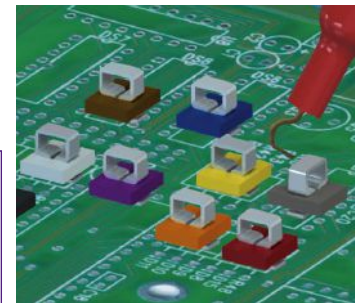
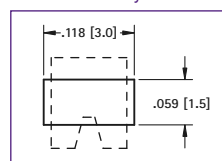

Tape & Reel Spec's: 12mm Wide, 4mm Pitch, 1,000 pieces per 7" reel

- Ideal for use with standard probes, clips and hooks
- Unique design provides exceptional strength and durability

COMPACT

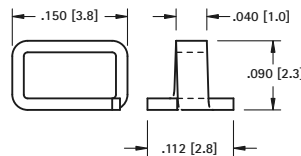

Pad Layout

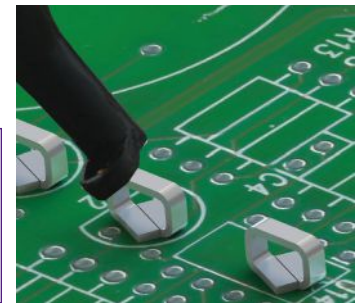
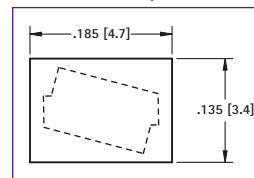

SPECIFICATIONS

Material:

.015 (.38) Phosphor Bronze, Silver Plate

CAT. NO. 5016 - 1000 pieces per reel **CAT. NO. 5018** - 5000 pieces per reel

Tape & Reel Spec's: 12mm Wide, 4mm Pitch

- Locating Pin provides positive location during assembly process
- Increased solder strength
- Can be used as a SMT test point or when used with a .032 [.81] board, as a THM test point

HYBRID MOUNT

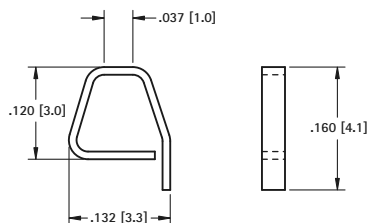

Pad Layout

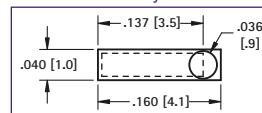

SPECIFICATIONS

Material:

.010 (.25) Phosphor Bronze, Silver Plate

CAT. NO. 5027 - 800 pieces per reel

Tape & Reel Spec's: 12mm Wide, 4mm Pitch

(THM) THRU HOLE MOUNT TEST POINTS - COLOR KEYED

- Color keyed for visibility and quick identification
- Economical choice for PC test point terminations
- Snap-fit mounting provides positive retention for wave soldering
- Wire form loop for safe, non-slip testing
- Space saving, ultra low and low profile designs
- High profile design for difficult to reach applications
- Suitable for high density packaging on .062 (1.57) and .093 (2.36) PC boards
- Practical replacement for wire-wrap posts and turrets
- Secure grip for J hooks, EZ hooks, grabbers, alligator clips, tips or probes
- High temperature nylon base ideal for reflow soldering
- Ideal for reliable production testing and field service troubleshooting



COLOR KEYED

MINIATURE

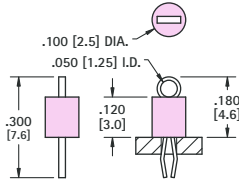

SPECIFICATIONS

Terminal:

.010 (.25) x .020 (.51) Phosphor Bronze, Silver Plate

Base: Nylon 46, UL Rated 94V-0

Mtg. Hole: .040 (1.0) Diameter

CAT. NO.	BASE COLOR	CAT. NO.	BASE COLOR
5000	RED	5115	BROWN
5001	BLACK	5116	GREEN
5002	WHITE	5117	BLUE
5003	ORANGE	5118	GREY
5004	YELLOW	5119	PURPLE

COMPACT

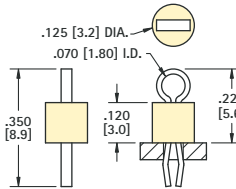

SPECIFICATIONS

Terminal:

.015 (.38) x .032 (.81) Phosphor Bronze, Silver Plate

Base: Nylon 46, UL Rated 94V-0

Mtg. Hole: .063 (1.6) Diameter

CAT. NO.	BASE COLOR	CAT. NO.	BASE COLOR
5005	RED	5120	BROWN
5006	BLACK	5121	GREEN
5007	WHITE	5122	BLUE
5008	ORANGE	5123	GREY
5009	YELLOW	5124	PURPLE

MULTIPURPOSE

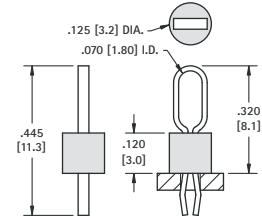

SPECIFICATIONS

Terminal:

.015 (.38) x .032 (.81) Phosphor Bronze, Silver Plate

Base: Nylon 46, UL Rated 94V-0

Mtg. Hole: .063 (1.6) Diameter

CAT. NO.	BASE COLOR	CAT. NO.	BASE COLOR
5010	RED	5125	BROWN
5011	BLACK	5126	GREEN
5012	WHITE	5127	BLUE
5013	ORANGE	5128	GREY
5014	YELLOW	5129	PURPLE

ULTRA LOW PROFILE

MATERIAL: .017 (.43) Dia. Phosphor Bronze Silver Plate
Mtg Hole: .040 (1.0)

CAT. NO. 5021

SHOWN AS INSTALLED INTO .040 [1.02] DIA. MOUNTING HOLE

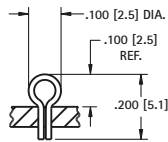

LOW PROFILE

MATERIAL: .016 (.40) x .028 (.71) Phosphor Bronze Silver Plate
Mtg Hole: .040 (1.0)

CAT. NO. 5020

SHOWN AS INSTALLED INTO .040 [1.02] DIA. MOUNTING HOLE

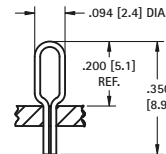

STANDARD

MATERIAL: .020 (.50) Dia. Phosphor Bronze Silver Plate
Mtg Hole: .073 (1.9)

CAT. NO. 5023

SHOWN AS INSTALLED INTO .067 [1.70] TO .078 [1.98] DIA. MOUNTING HOLE

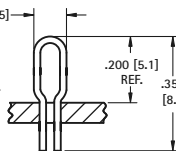

LARGE

MATERIAL: .020 (.50) Dia. Phosphor Bronze Silver Plate
Mtg Hole: .114 (2.9)

CAT. NO. 5024

SHOWN AS INSTALLED INTO .112 [2.84] TO .116 [2.95] DIA. MOUNTING HOLE

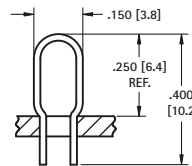

ALLIGATOR CLIPS



- Solder connection with strain relief
- Insulated or non-insulated
- Large clip also accepts standard banana plug

MATERIAL: Clip: Steel, Nickel Plate; Insulator: Vinyl



SMALL CLIP

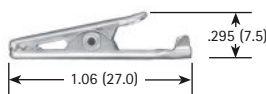

CAT. NO.	INSULATOR COLOR
5033	NONE
5034	RED
5035	BLACK
5036	GREEN
5037	YELLOW

JAW SPREAD
.236 (6.0) max.

MEDIUM CLIP



CAT. NO.	INSULATOR COLOR
5038	NONE
5039	RED
5040	BLACK

JAW SPREAD
.236 (6.0) max.

LARGE CLIP



CAT. NO.	INSULATOR COLOR
5044	NONE
5045	RED
5046	BLACK
5048*	NONE

JAW SPREAD
.315 (8.0) max.

*with screw

THM TEST POINTS - SLOTTED & LOOP TYPES



- Low profile, space saving designs for dense packaging
- Wide variety of configurations to suit most applications
- Safe, practical, economical replacement for wire-wrap posts
- Easy mount design, ideal for wave soldering
- Re-fit PC boards without need for re-design
- Provides easy access for production testing and field service troubleshooting
- Positive grip when using J hooks, EZ hooks, grabbers, clips, tips and probes
- Custom test point terminals can be manufactured to your specifications
- Other platings and materials available upon request

MATERIAL: Brass, Tin Plate

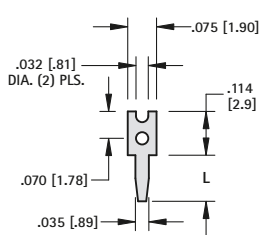

MATERIAL: .025 (.64) Brass

CAT. NO.	L
1030	.120 (3.0)
1031	.156 (4.0)

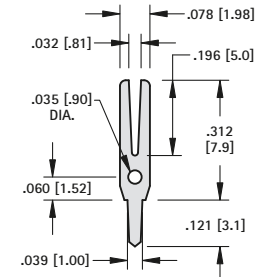

MATERIAL: .016 (.41) Brass

CAT. NO. 1037

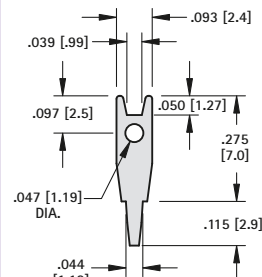

MATERIAL: .025 (.64) Brass

CAT. NO. 1036

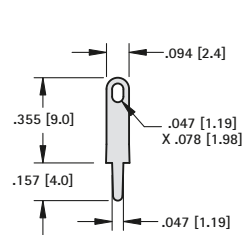

MATERIAL: .020 (.51) Brass

CAT. NO. 4953

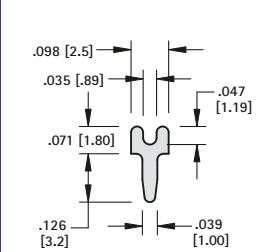

MATERIAL: .025 (.64) Brass

CAT. NO. 4950

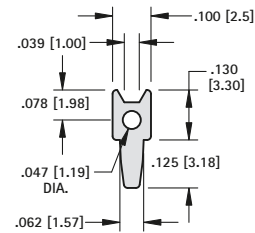

MATERIAL: .024 (.61) Brass

CAT. NO. 1032

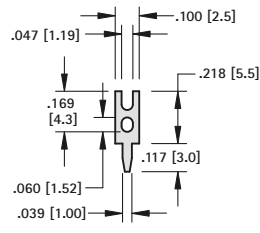

MATERIAL: .020 (.51) Brass

CAT. NO. 1035

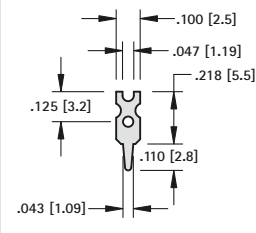

MATERIAL: .025 (.64) Brass

CAT. NO. 1034

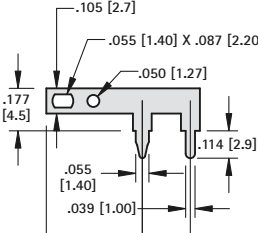

MATERIAL: .025 (.64) Brass

CAT. NO. 1045

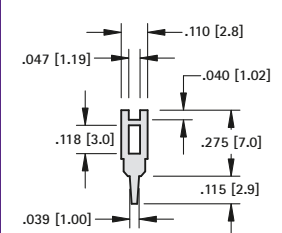

MATERIAL: .025 (.64) Brass

CAT. NO. 1040

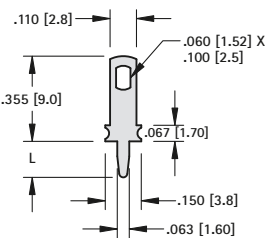

MATERIAL: .032 (.81) Brass

CAT. NO.	L
1041	.275 (7.0)
1046	.150 (3.8)

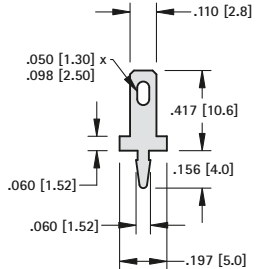

MATERIAL: .020 (.51) Brass

CAT. NO. 1250

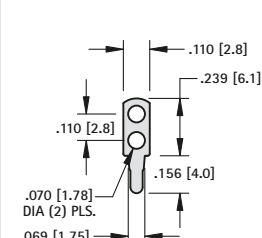

MATERIAL: .020 (.51) Brass

CAT. NO. 1038

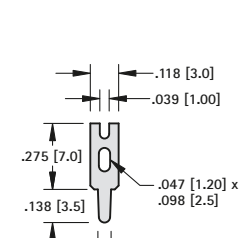

MATERIAL: .025 (.64) Brass

CAT. NO. 4951

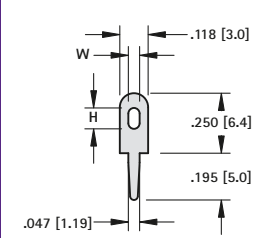

MATERIAL: .025 (.64) Brass

CAT. NO.	W	H
1249	.047 (1.19)	.087 (2.21)
4952	.063 (1.60)	.098 (2.49)

CUSTOM TERMINALS

Custom terminals can be machined to your exact specifications. Standard and special terminals can be staked onto special boards. Please email/fax your design to our Engineering Department.

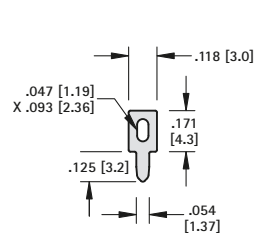

MATERIAL: .025 (.64) Brass

CAT. NO. 1033

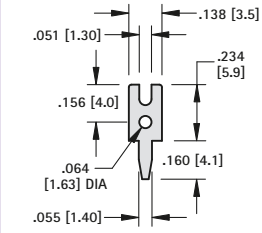

MATERIAL: .025 (.64) Brass

CAT. NO. 1039

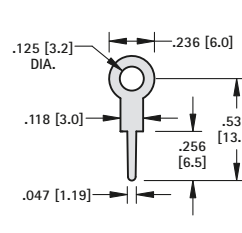

MATERIAL: .020 (.51) Brass

CAT. NO. 4954

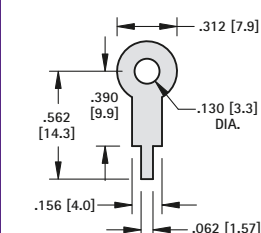

MATERIAL: .015 (.38) Brass

CAT. NO. 680



Underwriters Laboratories, Inc. Recognized Component Program — UL File Number E201546



UL file number E201546 has been assigned to Keystone Electronics' "Quick-Fit" terminals (Refer to pages 64-68) indicating recognition by Underwriters Laboratories Inc. that they are in compliance with their component program.

Underwriters Laboratories Inc. component program assures that "Quick-Fit" terminals meet the dimensional and performance requirements of the National Electrical Manufacturers Association specification number NEMA2-1982-(1988) and UL310.



.110 (2.8) TAB

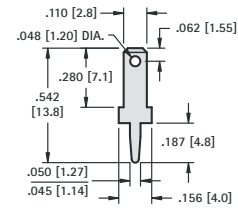

CAT. NO.	MATERIAL	MTG. HOLE
1267	.020 (.50) Brass, Tin Plate	.046 (1.2) Dia.
1211	.032 (.81) Brass, Tin Plate	.052 (1.3) Dia.

.110 (2.8) TAB

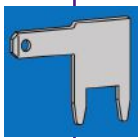
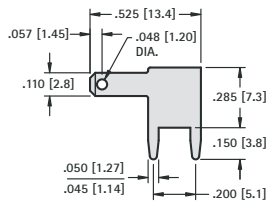

.110 (2.8) & .187 (4.8) TAB

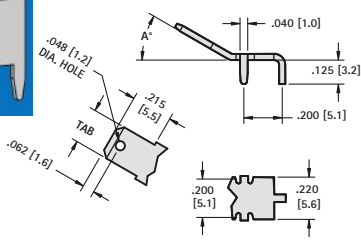

Material: .020 (.50) Brass, Tin Plate
Mtg Holes: .046 (1.2) Dia.

.110 (2.8) TAB CAT. NO.	A ANGLE	.187(4.8) TAB CAT. NO.
4915*	0°	4918*
4916*	30°	4919*
4917*	60°	4920*

CAT. NO.	MATERIAL	MTG. HOLES
4903	.020 (.50) Brass, Tin Plate	.046 (1.2) Dia.
4906	.032 (.81) Brass, Tin Plate	.052 (1.3) Dia.

.187 (4.8) TAB

STURDI-MOUNT

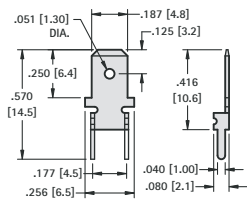

CAT. NO.	MATERIAL	MTG. HOLES
4900	.020 (.50) Brass, Tin Plate	.043 (1.1) Dia.

.187 (4.8) TAB

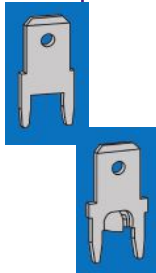
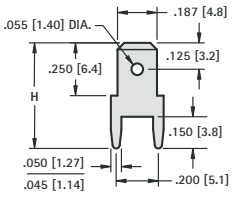

.187 (4.8) TAB

STURDI-MOUNT

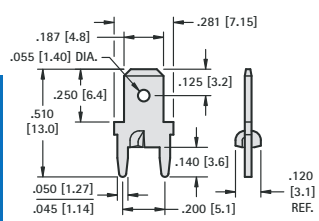

CAT. NO.	MATERIAL	MTG. HOLES
1285-ST	.020 (.50) Brass, Tin Plate	.046 (1.2) Dia.
1212-ST	.032 (.81) Brass, Tin Plate	.052 (1.3) Dia.

Material: Brass, Tin Plate

CAT. NO.	H	MATL THICK	MTG. HOLES
1285	.500 (12.7)	.020 (.50)	.046 (1.2) Dia.
1212	.500 (12.7)	.032 (.81)	.052 (1.3) Dia.
1216	.860 (21.8)	.032 (.81)	.052 (1.3) Dia.

.187 (4.8) TAB

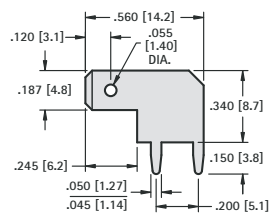

CAT. NO.	MATERIAL	MTG. HOLES
4904	.020 (.50) Brass, Tin Plate	.046 (1.2) Dia.
4907	.032 (.81) Brass, Tin Plate	.052 (1.3) Dia.

.205 (5.2) TAB

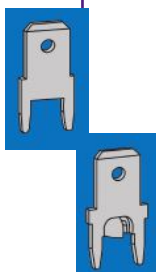
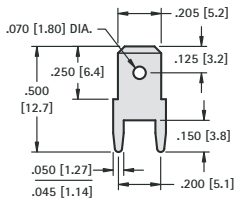

.205 (5.2) TAB

STURDI-MOUNT

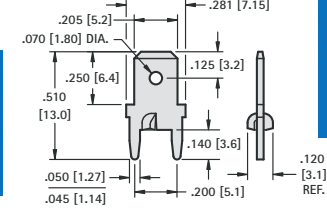

CAT. NO.	MATERIAL	MTG. HOLES
1286-ST	.020 (.50) Brass, Tin Plate	.046 (1.2) Dia.
1213-ST	.032 (.81) Brass, Tin Plate	.052 (1.3) Dia.

CAT. NO.	MATERIAL	MTG. HOLES
1286	.020 (.50) Brass, Tin Plate	.046 (1.2) Dia.
1213	.032 (.81) Brass, Tin Plate	.052 (1.3) Dia.

.205 (5.2) TAB

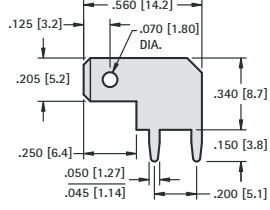

CAT. NO.	MATERIAL	MTG. HOLES
4905*	.020 (.50) Brass, Tin Plate	.046 (1.2) Dia.
4909*	.032 (.81) Brass, Tin Plate	.052 (1.3) Dia.

* Not UL Recognized

.250 (6.4) TAB

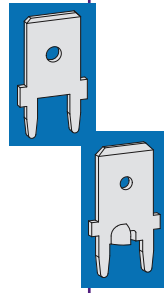
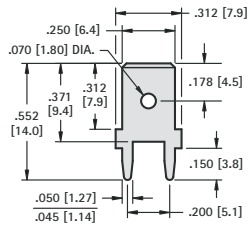

CAT. NO.	MATERIAL	MTG. HOLES
1287	.032 (.81) Brass, Tin Plate	.052 (1.3) Dia.

NOTE: see page 66 for continuous reel packaging

.250 (6.4) TAB

STURDI-MOUNT

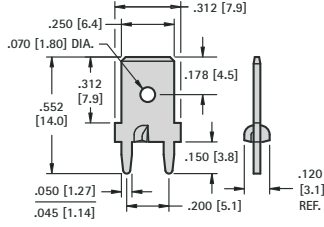

CAT. NO.	MATERIAL	MTG. HOLES
1287-ST	.032 (.81) Brass, Tin Plate	.052 (1.3) Dia.

NOTE: see page 66 for continuous reel packaging

DUAL .110 (2.8)/.250 (6.4) TAB

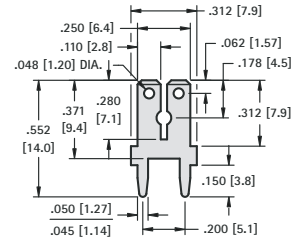

CAT. NO.	MATERIAL	MTG. HOLES
1282	.032 (.81) Brass, Tin Plate	.052 (1.3) Dia.

.250 (6.4) TAB

STURDI-MOUNT

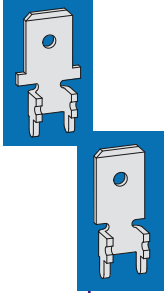
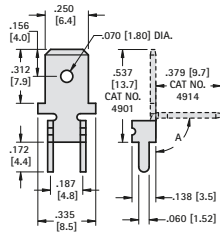

MATERIAL: .032 (.81) Brass, Matte Tin Plate

CAT. NO.	ANGLE A	MTG. HOLES
4901	0°	.067 (1.7) Dia.
4914	90°	

.250 (6.4) TAB

STURDI-MOUNT

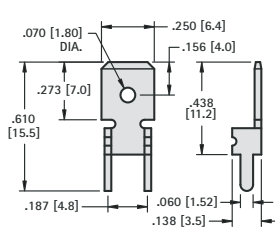

CAT. NO.	MATERIAL	MTG. HOLES
4902	.032 (.81) Brass, Tin Plate	.067 (1.7) Dia.

.250 (6.4) TAB

STURDI-MOUNT

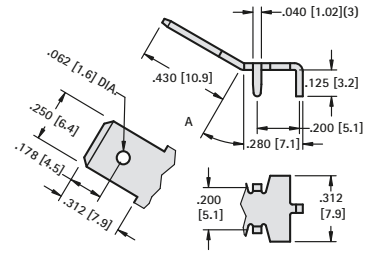

MATERIAL: .032 (.81) Brass, Matte Tin Plate

CAT. NO.	ANGLE A	MTG. HOLES
4910	0°	.052 (1.3) Dia.
4908	30°	
4912	60°	

.250 (6.4) TAB

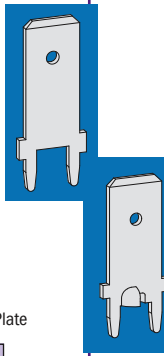
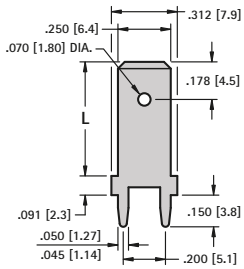

MATERIAL: .032 (.81) Brass, Matte Tin Plate

CAT. NO.	"L"	MTG. HOLES
1289	.540 (13.7)	.052 (1.3) Dia.
1203	.657 (16.7)	
1292	.710 (18.0)	
1225	1.039 (26.4)	

.250 (6.4) TAB

STURDI-MOUNT

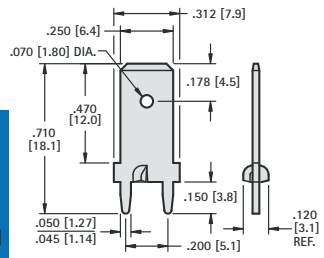

CAT. NO.	MATERIAL	MTG. HOLES
1289-ST	.032 (.81) Brass, Tin Plate	.052 (1.3) Dia.

NOTE: see page 66 for continuous reel packaging

.250 (6.4) TAB

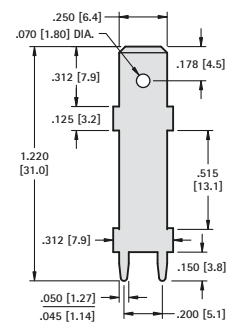

CAT. NO.	MATERIAL	MTG. HOLES
1281	.032 (.81) Brass, Tin Plate	.052 (1.3) Dia.

.250 (6.4) TAB

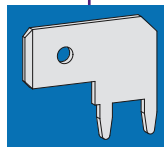
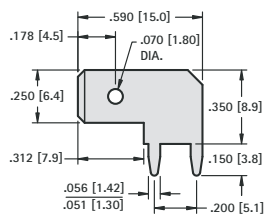

CAT. NO.	MATERIAL	MTG. HOLES
4966	.032 (.81) Brass, Tin Plate	.056 (1.4) Dia.

.250 (6.4) TAB

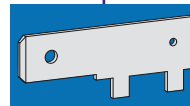
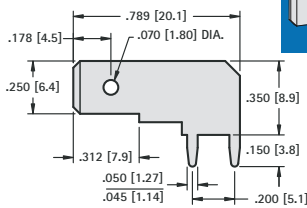

CAT. NO.	MATERIAL	MTG. HOLES
1266	.032 (.81) Brass, Tin Plate	.052 (1.3) Dia.

.250 (6.4) TAB

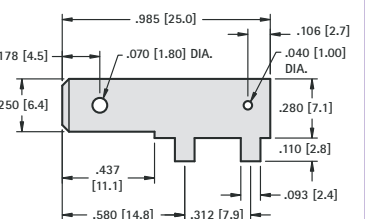

CAT. NO.	MATERIAL	MTG. HOLES
1265*	.032 (.81) Brass, Tin Plate	.106 (2.7) Dia.

* Not UL Recognized

REELED .250 (6.4) PC QUICK-FIT MALE TERMINALS

Underwriters Laboratories, Inc.
 Recognized Component Program —
 UL File Number E201546



UL file number E201546 has been assigned to Keystone Electronics' "Quick-Fit" terminals (Refer to pages 64-68) indicating recognition by Underwriters Laboratories Inc. that they are in compliance with their component program.

Underwriters Laboratories Inc. component program assures that "Quick-Fit" terminals meet the dimensional and performance requirements of the National Electrical Manufacturers Association specification number NEMA2-1982-(1988) and UL310.

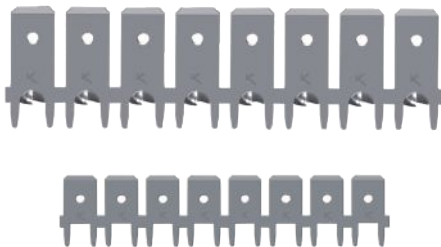
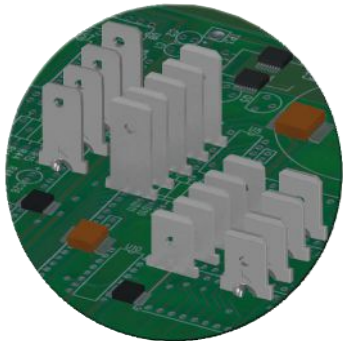

• Supplied in continuous reel for automated pick and place insertion

.250 (6.4) TAB

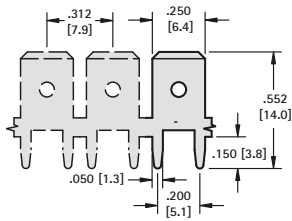

CAT. NO.	MATERIAL	MTG. HOLES
1287-R	.032 (.81) Brass, Tin Plate	.052 (1.3) Dia.

Tape & Reel Spec's: 12,500 per 15 inch reel

.250 (6.4) TAB

STURDI-MOUNT

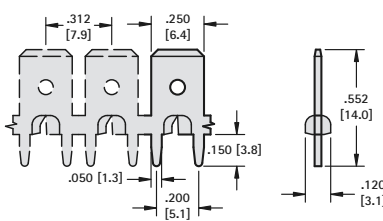

CAT. NO.	MATERIAL	MTG. HOLES
1287-STR	.032 (.81) Brass, Tin Plate	.052 (1.3) Dia.

Tape & Reel Spec's: 15,000 per 24 inch reel

.250 (6.4) TAB

STURDI-MOUNT

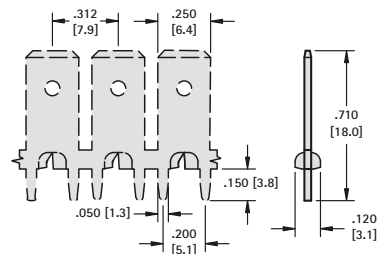

CAT. NO.	MATERIAL	MTG. HOLES
1289-STR	.032 (.81) Brass, Tin Plate	.052 (1.3) Dia.

Tape & Reel Spec's: 15,000 per 24 inch reel

BULK .250 (6.4) PC QUICK-FIT MALE TABS

.250 (6.4) TAB

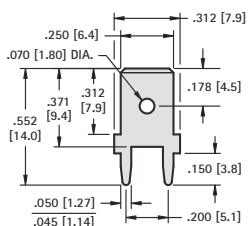

CAT. NO.	MATERIAL	MTG. HOLES
1287	.032 (.81) Brass, Tin Plate	.052 (1.3) Dia.

.250 (6.4) TAB

STURDI-MOUNT

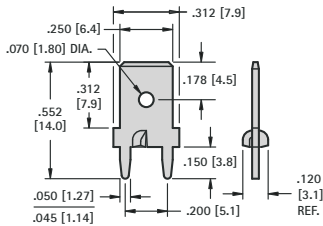

CAT. NO.	MATERIAL	MTG. HOLES
1287-ST	.032 (.81) Brass, Tin Plate	.052 (1.3) Dia.

.250 (6.4) TAB

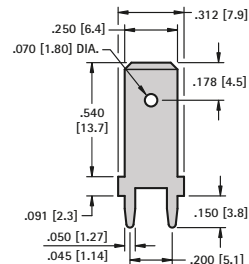

CAT. NO.	MATERIAL	MTG. HOLES
1289	.032 (.81) Brass, Tin Plate	.052 (1.3) Dia.

SMT .250 (6.4) QUICK-FIT TERMINALS

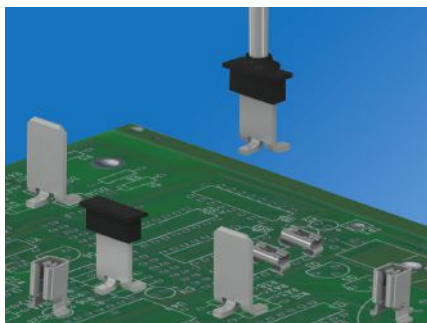

AVAILABLE ON TAPE AND REEL

.250 (6.4) TAB

VERTICAL - MALE

- Designed for automated assembly processing
- Available on tape and reel for automated assembly. Pick-up cap added to reeled parts to accommodate vacuum pick and place assembly
- Reflow solder compatible. Plastic pick-up cap will survive reflow temperatures

CAT. NO.	ON TAPE & REEL	MATERIAL
4928*	4928TR*	.032 (.81) Brass, Tin Plate

Tape & Reel Spec's: 16mm wide, 12mm pitch, 13 inch reel (750 pieces per reel)

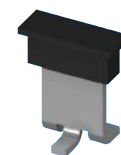
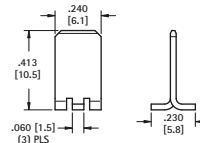

Mounting Detail

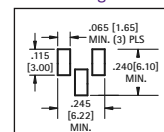

PC QUICK-FIT MALE TERMINALS 



.250 (6.4) "STURDI-MOUNT" PC QUICK-FIT HEADERS

AVAILABLE IN BRASS OR STEEL TABS



- Ideal for rugged multi-insertion applications
- Pre-assembled header reduces PC assembly costs
- Increases PC board retention strength
- Keeps terminals perpendicular
- Maintains position for wave soldering

SPECIFICATIONS

Material: .032 (.81) Brass or Steel, Tin Plated
Insulator: Thermoplastic, UL Rated 94V-0
Current Rating: 15 Amps @ 500V AC
Temperature Rating: -58°F to +292°F (-50°C to +145°C)

HORIZONTAL

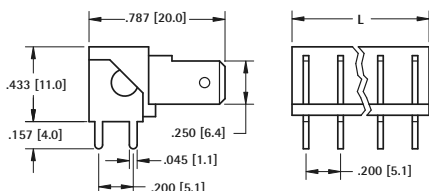

BRASS TABS	STEEL TABS	NO. OF TABS	L DIM.
CAT. NO.	CAT. NO.		
7802	7822	2	.362 (8.2)
7803	7823	3	.562 (14.3)
7804	7824	4	.762 (19.4)
7805	7825	5	.962 (24.4)
7806	7826	6	1.162 (29.5)

VERTICAL

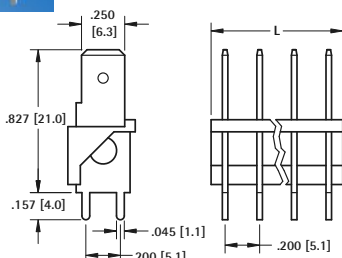

BRASS TABS	STEEL TABS	NO. OF TABS	L DIM.
CAT. NO.	CAT. NO.		
7812	7832	2	.362 (8.2)
7813	7833	3	.562 (14.3)
7814	7834	4	.762 (19.4)
7815	7835	5	.962 (24.4)
7816	7836	6	1.162 (29.5)

LOW PROFILE

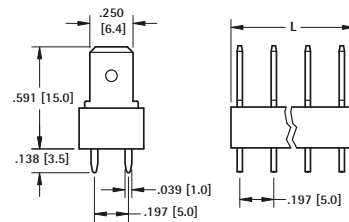

BRASS TABS	STEEL TABS	NO. OF TABS	L DIM.
CAT. NO.	CAT. NO.		
7817	7827	2	.320 (.81)
7818	7828	3	.517 (13.1)
7819	7829	4	.713 (18.1)
7820	7830	5	.910 (23.1)
7821	7831	6	1.107 (28.1)

RIVET MOUNT QUICK-FIT TERMINALS



- UL recognized bright brass Quick-Fit terminals
- Rivet mount male tab versions meet NEMA 2-E201546 & UL 310 specifications
- Designed for repeated mating cycles
- For tabs 0.110 (2.8mm) to 0.250 (6.4mm)

.110 (2.8) - .187(4.8) - .250 (6.4) TABS

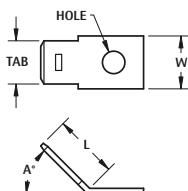
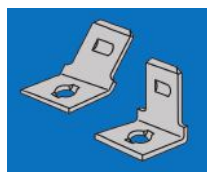

BRIGHT BRASS							MATTE TIN	
A = 45°	A = 90°	TAB SIZE	MAT'L THICK	TAB	W WIDTH	HOLE DIA.	A = 45°	A = 90°
CAT. NO.	CAT. NO.						CAT. NO.	CAT. NO.
2004	2002	.110 (2.8)	.020 (.51)	.365 (9.3)	.180 (4.6)	.096 (2.4)	1233	1220
1271	1261	.187 (4.8)	.020 (.51)	.375 (9.5)	.250 (6.4)	.100 (2.5)	1234	1221
1280	1256	.250 (6.4)	.032 (.81)	.406 (10.3)	.306 (7.8)	.130 (3.3)	1235	1222

.110 (2.8) - .187 (4.8) - .250 (6.4) TABS

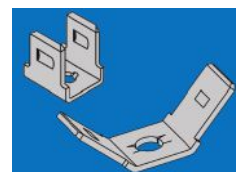
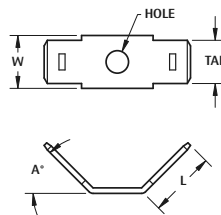

BRIGHT BRASS							MATTE TIN	
A = 45°	A = 90°	TAB SIZE	MAT'L THICK	TAB	W WIDTH	HOLE DIA.	A = 45°	A = 90°
CAT. NO.	CAT. NO.						CAT. NO.	CAT. NO.
2005	2003	.110 (2.8)	.020 (.51)	.360 (9.1)	.180 (4.6)	.096 (2.4)	1240	1227
1263	1262	.187 (4.8)	.020 (.51)	.315 (8.0)	.250 (6.4)	.100 (2.5)	1241	1228
1258	1257	.250 (6.4)	.032 (.81)	.400 (10.1)	.306 (7.8)	.130 (3.3)	1242	1229

.110 (2.8) TAB

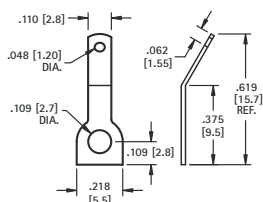

MATERIAL: .020 (.51) Brass, Tin Plate

CAT. NO.	ANGLE
1269	0°
1270	30°

.187 (4.8) - .205 (6.4) TABS

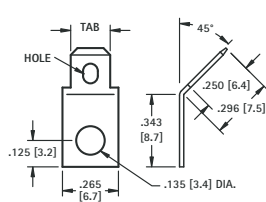

45° TAB MATERIAL: .020 (.51) Brass, Tin Plate

CAT. NO.	TAB	HOLE
4005	.205 (5.2)	.132 (3.4) x .070 (1.78) Slot
4095	.187 (4.7)	.078 (1.98) Dia. Hole

MULTIPLE .250 (6.4) TAB

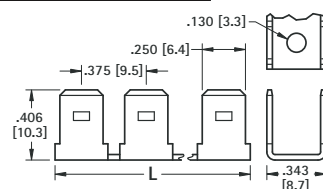
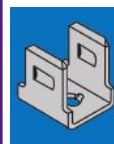

BRIGHT BRASS MATERIAL: .032 (.81) Bright Brass			
CAT. NO.	PAIRS	L	TAB SIZE
1005	2	.687 (17.4)	.250 (6.4)
1006	3	1.062 (27.0)	.250 (6.4)
1007	4	1.441 (36.6)	.250 (6.4)
1008	5	1.820 (46.2)	.250 (6.4)

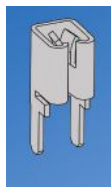

ACCEPTS ALL TABS
 .110 (2.8) TO .250 (6.4) x .020 (.50) TO .032 (.81)

VERTICAL OR HORIZONTAL ENTRY

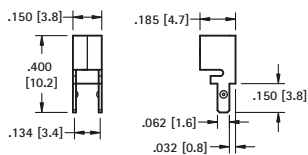

MATERIAL:
 .016 (.41) Brass, Tin-Nickel Plate

CAT. NO.	ORIENTATION
3557	top & side entry

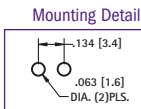

BOTTOM ENTRY

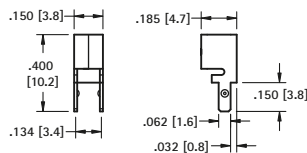

MATERIAL:
 .016 (.41) Brass, Tin-Nickel Plate

CAT. NO.	ORIENTATION
3577	bottom entry

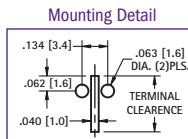

Underwriters Laboratories, Inc.
 Recognized Component Program
 — UL File Number E201546

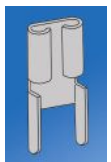

ACCEPTS .110 (2.8) TAB

VERTICAL ENTRY

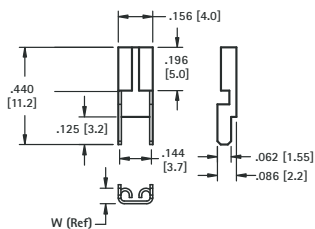

MATERIAL:
 .012 (.30) Brass, Tin-Nickel Plate

CAT. NO.	ACCEPTS TAB	W
3534	.110 (2.8) x .020 (.51)	.070 (1.80)
3544	.110 (2.8) x .032 (.81)	.075 (1.92)

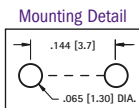

ACCEPTS .187 (4.8) TAB

VERTICAL ENTRY

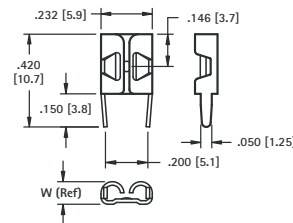

MATERIAL: .016 (.41) Brass, Tin-Nickel Plate

CAT. NO.	ACCEPTS TAB	"W"
3548	.187 (4.8) x .020 (.51)	.093 (2.36)
3578†	.187 (4.8) x .020 (.51)	.093 (2.36)
3551	.187 (4.8) x .032 (.81)	.102 (2.59)

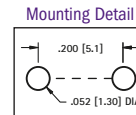

†Low insertion force design

ACCEPTS .205 (5.2) TAB

VERTICAL ENTRY

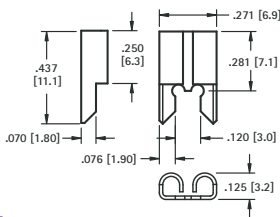

MATERIAL:
 .016 (.41) Brass, Tin-Nickel Plate

CAT. NO.	ACCEPTS TAB
3525	.205 (5.2) x .020 (.51)
3575*	.205 (5.2) x .032 (.81)

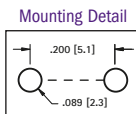

ACCEPTS .250 (6.4) TAB

VERTICAL ENTRY

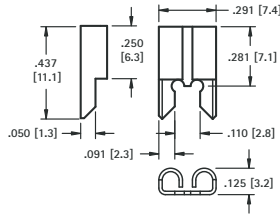

MATERIAL:
 .016 (.41) Brass, Tin-Nickel Plate

CAT. NO.	ACCEPTS TAB
3528	.250 (6.4) x .032 (.81)

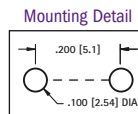

ACCEPTS .312 (7.9) TAB

OVER SIZED

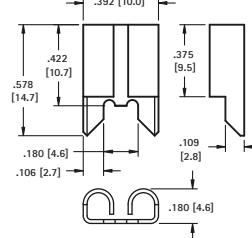

MATERIAL:
 .020 (.51) Copper, Tin-Nickel Plate

CAT. NO. 3555

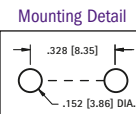

ACCEPTS .110 (2.8) TAB

HORIZONTAL ENTRY

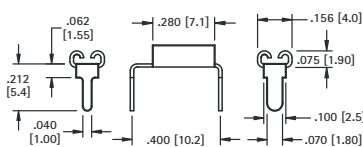

MATERIAL:
 .012 (.30) Brass, Tin-Nickel Plate

CAT. NO.	ACCEPTS TAB
3545	.110 (2.8) x .020 (.51)
3549	.110 (2.8) x .032 (.81)

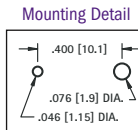

ACCEPTS .187 (4.8), .205 (5.2), .250 (6.4) TAB

HORIZONTAL ENTRY

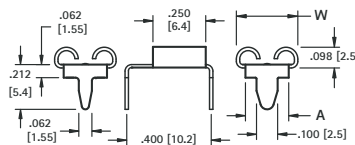

MATERIAL: Brass, Tin-Nickel Plate

CAT. NO.	ACCEPTS TAB	"W"	"A"	MATL THICK
3571	.187 (4.8) x .020 (.51)	.222 (5.6)	.162 (4.1)	.012 (.30)
3572*	.187 (4.8) x .032 (.81)			
3546	.205 (5.2) x .020 (.51)			
3550	.205 (5.2) x .032 (.81)	.240 (6.1)	.180 (4.6)	.012 (.30)
3547	.250 (6.4) x .032 (.81)	.291 (7.4)	.205 (5.2)	.016 (.41)

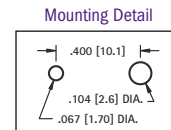

* Not UL Recognized

SMT QUICK-FIT FEMALE TERMINALS

AVAILABLE ON TAPE AND REEL



ACCEPTS ALL TABS
VERTICAL OR HORIZONTAL ENTRY

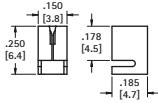

SPECIFICATIONS

Material: .016 (.41) Brass, Tin-Nickel Plate
Current Rating: 15 Amps @ 500V AC

CAT. NO. 3584 (Bulk)

CAT. NO. 3584KTR (Tape & Reel)

Tape & Reel Spec's: 16mm wide, 12mm pitch, 13 inch reel (750 pieces per reel)

ACCEPTS ALL TABS
VERTICAL OR HORIZONTAL ENTRY

KTR parts have Kapton Tape added to top surface for vacuum pick & place

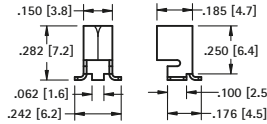

SPECIFICATIONS

Material: .016 (.41) Brass, Tin-Nickel Plate
Current Rating: 15 Amps @ 500V AC

CAT. NO. 3586 (Bulk)

CAT. NO. 3586KTR (Tape & Reel)

Tape & Reel Spec's: 16mm wide, 12mm pitch, 13 inch reel (750 pieces per reel)



ACCEPTS .110 (2.8) × .032 (.81) TAB
HORIZONTAL ENTRY

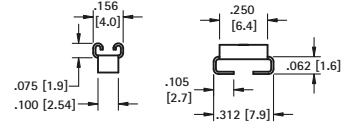

SPECIFICATIONS

Material: .012 (.30) Brass, Matte Tin Plate
Current Rating: 15 Amps @ 500V AC

CAT. NO. 3569 (Bulk)

CAT. NO. 3569TR (Tape & Reel)

Tape & Reel Spec's: 24mm wide, 8mm pitch, 13 inch reel (2000 pieces per reel)

SMT .110 (2.8) TAB EDGE CONNECTOR

AVAILABLE ON TAPE AND REEL

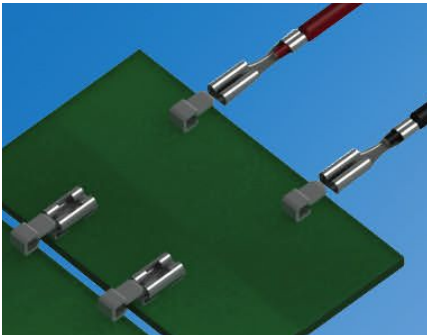

CAT. NO. 3579 Bulk

CAT. NO. 3579TR (Tape & Reel)

Tape & Reel Spec's: 24mm wide, 8mm pitch, 13 inch reel (1000 pieces per reel)

- Designed to pass signals or voltage across boards
- Generous lead-in guide aid in board assembly
- Designed to be used with **Cat. No. 3569**
- .110 tab design also allows standard crimp terminals to be used, see page 70
- Compatible with most automated assembly processes

SPECIFICATIONS

Material: Brass, Tin Plate
Current Rating: 10 Amps
Operating Temperature: -40°F to +257°F (-40°C to 125°C)
Life: 100 cycles

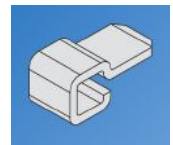
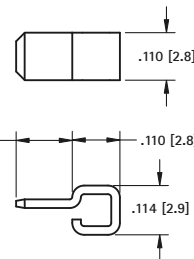
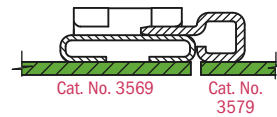

Pad Layout

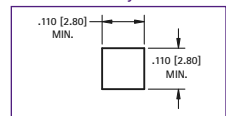

SMT LOW PROFILE EDGE CONNECTORS

AVAILABLE ON TAPE AND REEL

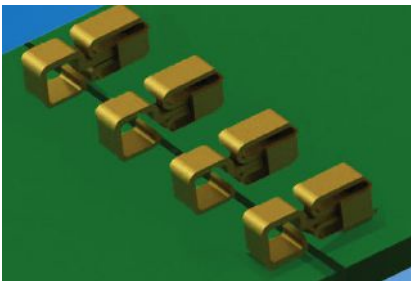

- Designed to pass signals or power across boards
- Generous lead-in guide aid in board assembly
- Gold plating provides superior solderability as well as low contact resistance
- Compatible with most automated assembly processes

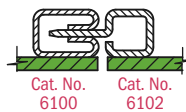

Cat. No. 6100

Cat. No. 6102

SPECIFICATIONS

Material: Phosphor Bronze, Gold Plate
Current Rating: 10 Amps
Operating Temperature: -40°F to +257°F (-40°C to 125°C)
Life: 100 cycles

SMT EDGE PIN

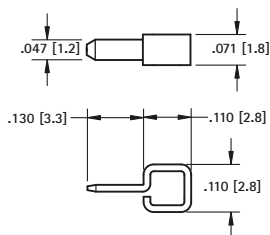

CAT. NO. 6100 Bulk

CAT. NO. 6100TR (Tape & Reel)

Tape & Reel Spec's: 16mm wide, 8mm pitch, 7 inch reel (500 pieces per reel)

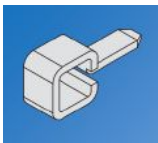

Pad Layout

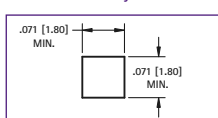

SMT EDGE SOCKET

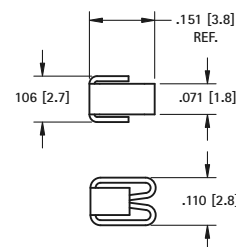

CAT. NO. 6102 Bulk

CAT. NO. 6102TR (Tape & Reel)

Tape & Reel Spec's: 12mm wide, 4mm pitch, 7 inch reel (500 pieces per reel)



Pad Layout

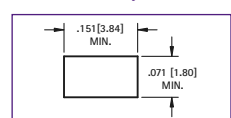



QUICK-FIT FEMALES

FEMALE NON-INSULATED

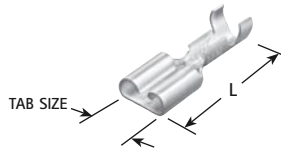

For .250 (6.4) QUICK-FITS

- Easily slips over terminal
- Insulates and protects

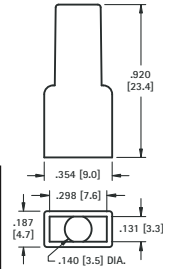

MATERIAL: Tinned Brass

Boot and Quick-Fit sold separately

CAT. NO.	MATES WITH MALE TAB WIDTH × THICK	L	AWG SIZE	MAT'L THICK
1252	.110 (2.8) × .020 (.51)	.606 (15.4)	18-22	.010 (.25)
1264	.187 (4.8) × .020 (.51)	.576 (14.6)	16-22	.013 (.33)
4469	.205 (5.2) × .020 (.51)	.640 (16.3)	16-20	.013 (.33)
4470	.250 (6.4) × .032 (.81)	.750 (19.1)	16-20	.016 (.41)

CAT. NO.	BOOT COLOR
4471	CLEAR
4472	RED
4473	BLUE

SOLDERLESS QUICK-FIT TERMINALS

SPECIFICATIONS: Terminals: EPT Copper Insulation: Vinyl

MALE NON-INSULATED

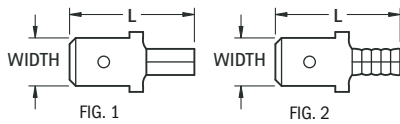

CAT. NO.	WIRE RANGE (AWG)	FIG.	MALE TAB		BARREL		
			WIDTH × THICK	L	LENGTH	I.D.	
8281	22/18	2	.187 (4.8) × .020 (.51)	.64 (16.3)	.24 (6.1)	.080 (2.03)	
8282		1	.250 (6.4) × .032 (.81)	.73 (18.5)	.25 (6.4)	.065 (1.65)	
8283	16/14	2	.187 (4.8) × .020 (.51)	.64 (16.3)	.24 (6.1)	.080 (2.03)	
8284		1	.250 (6.4) × .032 (.81)	.73 (18.5)	.25 (6.4)	.085 (2.16)	
8285	12/10	1	.250 (6.4) × .032 (.81)	.75 (19.1)	.25 (6.4)	.150 (3.81)	

FEMALE NON-INSULATED

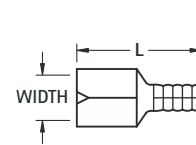

CAT. NO.	WIRE RANGE (AWG)	MATES WITH MALE TAB		L	BARREL .250 (6.4)	
		WIDTH × THICK	L		I.D.	
8272	22/18	.187 (4.8) × .020 (.51)	.58 (14.7)	.085 (2.16)		
8273		.250 (6.4) × .032 (.81)	.66 (16.8)	.080 (2.03)		
8274	16/14	.187 (4.8) × .020 (.51)	.58 (14.7)	.085 (2.16)		
8275		.250 (6.4) × .032 (.81)	.66 (16.8)	.080 (2.03)		

MALE VINYL INSULATED

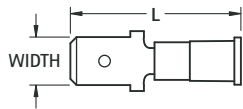

CAT. NO.	WIRE RANGE (AWG)	MALE TAB		BARREL			MAX INSULATION DIAMETER
		WIDTH × THICK	L	LENGTH	I.D.		
8286	22/18	.187 (4.8) × .020 (.51)	.85 (21.6)	.24 (6.1)	.080 (2.03)	.145 (3.7)	
8287		(Red)	.250 (6.4) × .032 (.81)	.93 (23.6)	.25 (6.4)	.065 (1.65)	.145 (3.7)
8288	16/14	.187 (4.8) × .020 (.51)	.85 (21.6)	.24 (6.1)	.080 (2.03)	.145 (3.7)	
8289		(Blue)	.250 (6.4) × .032 (.81)	.93 (23.6)	.25 (6.4)	.085 (2.16)	.170 (4.3)
8290	12/10 (Yellow)	.250 (6.4) × .032 (.81)	1.05 (26.7)	.25 (6.4)	.150 (3.81)	.250 (6.4)	

FEMALE VINYL INSULATED

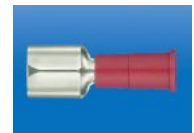
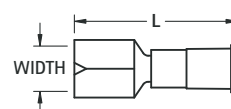

CAT. NO.	WIRE RANGE (AWG)	MATES WITH MALE TAB		L	BARREL .250 (6.4)		MAX INSULATION DIAMETER
		WIDTH × THICK	L		I.D.		
8276	22/18	.187 (4.8) × .020 (.51)	.78 (19.8)	.085 (2.16)			
8277		(Red)	.250 (6.4) × .032 (.81)	.87 (22.1)	.080 (2.03)		
8278	16/14	.187 (4.8) × .020 (.51)	.78 (19.8)	.085 (2.16)			
8279		(Blue)	.250 (6.4) × .032 (.81)	.87 (22.1)	.080 (2.03)		
8280	12/10 (Yellow)	.250 (6.4) × .032 (.81)	.96 (24.4)	.165 (4.19)	.250 (6.4)		

MALE FULLY INSULATED NYLON

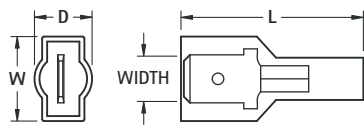

CAT. NO.	WIRE RANGE (AWG)	MALE TAB		L	W	D	BARREL .250 (6.4)		MAX. INSUL. DIA.
		WIDTH × THICK	L				LENGTH	I.D.	
8296	22/18	.187 (4.8) × .020 (.51)	.87 (22.1)	.37 (9.4)	.30 (7.6)	.24 (6.1)	.080 (2.03)	.145 (3.7)	
8297		(Red)	.250 (6.4) × .032 (.81)	.95 (24.1)	.44 (11.2)	.30 (7.6)	.25 (6.4)	.065 (1.65)	.145 (3.7)
8298	16/14	.187 (4.8) × .020 (.51)	.87 (22.1)	.37 (9.4)	.30 (7.6)	.24 (6.1)	.080 (2.03)	.170 (4.3)	
8299		(Blue)	.250 (6.4) × .032 (.81)	.95 (24.1)	.44 (11.2)	.30 (7.6)	.25 (6.4)	.085 (2.16)	.170 (4.3)
8300	12/10 (Yellow)	.250 (6.4) × .032 (.81)	1.05 (26.7)	.47 (11.9)	.39 (9.9)	.25 (6.4)	.150 (3.81)	.250 (6.4)	

FEMALE FULLY INSULATED NYLON

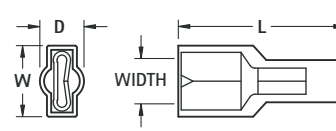

CAT. NO.	WIRE RANGE (AWG)	MATES WITH MALE TAB		L	W	D	BARREL .250 (6.4)		MAX. INSUL. DIA.
		WIDTH × THICK	L				I.D.		
8291	22/18	.187 (4.8) × .020 (.51)	.81 (20.6)	.30 (7.6)	.23 (5.8)	.085 (2.16)	.145 (3.7)		
8292		(Red)	.250 (6.4) × .032 (.81)	.87 (22.1)	.37 (9.4)	.23 (5.8)	.080 (2.03)	.145 (3.7)	
8293	16/14	.187 (4.8) × .020 (.51)	.81 (20.6)	.30 (7.6)	.23 (5.8)	.085 (2.16)	.145 (3.7)		
8294		(Blue)	.250 (6.4) × .032 (.81)	.87 (22.1)	.37 (9.4)	.23 (5.8)	.080 (2.03)	.170 (4.3)	
8295	12/10 (Yellow)	.250 (6.4) × .032 (.81)	.99 (25.1)	.39 (9.9)	.32 (8.1)	.165 (4.19)	.250 (6.4)		

SOLDERLESS TERMINALS

SPECIFICATIONS: Terminals: EPT Copper Insulation: Vinyl

RING TONGUE NON-INSULATED

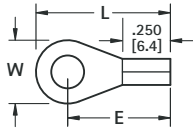

CAT. NO.	WIRE RANGE (AWG)	FOR STUD SIZE	W	L	E	MATL THICK	BARREL I.D.
8200	22/18	6	.25 (6.4)	.60 (15.2)	.47 (11.9)	.030 (.76)	.070 (1.78)
8201		8	.33 (8.4)	.70 (17.8)	.54 (13.7)		
8202		10	.33 (8.4)	.70 (17.8)	.54 (13.7)		
8203	16/14	6	.25 (6.4)	.60 (15.2)	.47 (11.9)	.030 (.76)	.090 (2.29)
8204		8	.33 (8.4)	.70 (17.8)	.54 (13.7)		
8205		10	.33 (8.4)	.70 (17.8)	.54 (13.7)		
8206	12/10	6	.28 (7.1)	.68 (17.3)	.54 (13.7)	.040 (1.02)	.135 (3.43)
8207		8	.38 (9.7)	.73 (18.5)	.54 (13.7)		
8208		10	.38 (9.7)	.73 (18.5)	.54 (13.7)		

RING TONGUE INSULATED

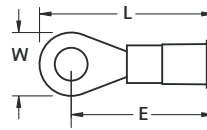

CAT. NO.	WIRE RANGE (AWG)	FOR STUD SIZE	W	L	E	MATL THICK	BARREL .250 (6.4) LONG I.D.	MAX. INSUL. DIA.
8209	22/18 (Red)	6	.25 (6.4)	.80 (20.3)	.67 (17.0)	.030 (.76)	.070 (1.78)	.145 (3.7)
8210		8	.33 (8.4)	.90 (22.9)	.74 (18.8)			
8211		10	.33 (8.4)	.90 (22.9)	.74 (18.8)			
8212	16/14 (Blue)	6	.25 (6.4)	.80 (20.3)	.67 (17.0)	.030 (.76)	.090 (2.29)	.170 (4.3)
8213		8	.33 (8.4)	.90 (22.9)	.74 (18.8)			
8214		10	.33 (8.4)	.90 (22.9)	.74 (18.8)			
8215	12/10 (Yellow)	6	.28 (7.1)	.98 (24.9)	.84 (21.3)	.040 (1.02)	.135 (3.43)	.250 (6.4)
8216		8	.38 (9.7)	1.03 (26.2)	.84 (21.3)			
8217		10	.38 (9.7)	1.03 (26.2)	.84 (21.3)			

BLOCK SPADE NON-INSULATED

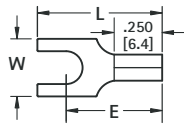
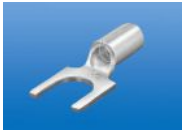

Flanged

CAT. NO.	WIRE RANGE (AWG)	FOR STUD SIZE	W	L	E	MATL THICK	BARREL I.D.	FLANGED CAT. NO.
8218	22/18	6	.30 (7.6)	.65 (16.5)	.50 (12.7)	.030 (.76)	.090 (2.29)	8236
8219		8						8237
8220		10						8238
8221	16/14	6	.30 (7.6)	.65 (16.5)	.50 (12.7)	.030 (.76)	.090 (2.29)	8239
8222		8						8240
8223		10						8241
8224	12/10	6	.32 (8.1)	.73 (18.5)	.54 (13.7)	.040 (1.02)	.135 (3.43)	8242
8225		8						8243
8226		10						8244

BLOCK SPADE INSULATED

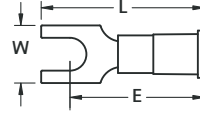

Flanged

CAT. NO.	WIRE RANGE (AWG)	FOR STUD SIZE	W	L	E	MATL THICK	BARREL .250 (6.4) LONG I.D.	MAX. INSUL. DIA.	FLANGED CAT. NO.
8227	22/18 (Red)	6	.30 (7.6)	.85 (21.6)	.70 (17.8)	.030 (.76)	.070 (1.78)	.145 (3.7)	8245
8228		8							8246
8229		10							8247
8230	16/14 (Blue)	6	.30 (7.6)	.85 (21.6)	.70 (17.8)	.030 (.76)	.090 (2.29)	.175 (4.4)	8248
8231		8							8249
8232		10							8250
8233	12/10 (Yellow)	6	.32 (8.1)	1.03 (26.2)	.84 (21.3)	.040 (1.02)	.135 (3.43)	.255 (6.5)	8251
8234		8							8252
—		10							8253

SNAP SPADE NON-INSULATED

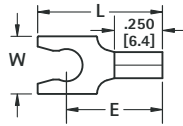

CAT. NO.	WIRE RANGE (AWG)	FOR STUD SIZE	W	L	E	MATL THICK	BARREL I.D.
8254	22/18	6	.25 (6.4)	.68 (17.3)	.50 (12.7)	.030 (.76)	.070 (1.78)
8255		8	.30 (7.6)				
8256		10	.32 (8.1)				
8257	16/14	6	.25 (6.4)	.68 (17.3)	.50 (12.7)	.030 (.76)	.090 (2.29)
8258		8	.30 (7.6)				
8259		10	.32 (8.1)				
8260	12/10	6	.28 (7.1)	.73 (18.5)	.53 (13.5)	.040 (1.02)	.135 (3.43)
8261		8	.32 (8.1)				
8262		10	.32 (8.1)				

SNAP SPADE INSULATED

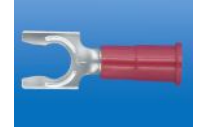
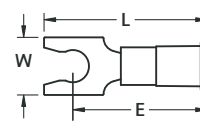

CAT. NO.	WIRE RANGE (AWG)	FOR STUD SIZE	W	L	E	MATL THICK	BARREL .250 (6.4) LONG I.D.	MAX. INSUL. DIA.
8263	22/18 (Red)	6	.25 (6.4)	.88 (22.4)	.70 (17.8)	.030 (.76)	.070 (1.78)	.145 (3.7)
8264		8	.30 (7.6)					
8265		10	.32 (8.1)					
8266	16/14 (Blue)	6	.25 (6.4)	.88 (22.4)	.70 (17.8)	.030 (.76)	.090 (2.29)	.170 (4.3)
8267		8	.30 (7.6)					
8268		10	.32 (8.1)					
8269	12/10 (Yellow)	6	.28 (7.1)	1.03 (26.2)	.83 (21.2)	.040 (1.02)	.135 (3.43)	.250 (6.4)
8270		8	.32 (8.1)					
8271		10	.32 (8.1)					

HAND CRIMP TOOL

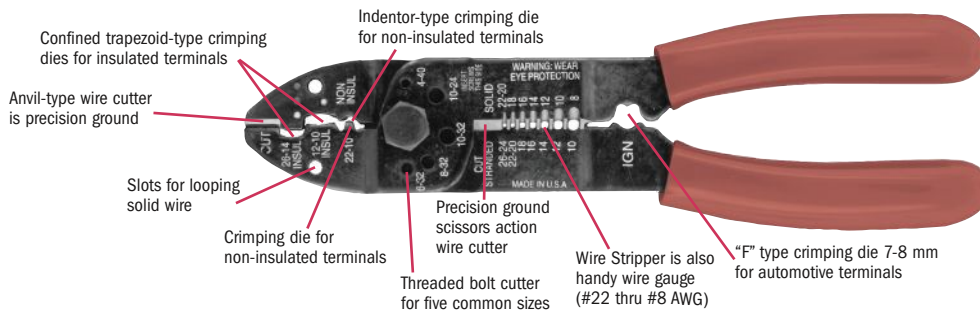

CAT. NO. 1345

Tel (516) 328-7500 • Fax (516) 328-1080
(800) 221-5510 • kec@keyelco.com

KEYSTONE
RoHS COMPLIANT ~ ISO 9001 CERTIFIED

www.keyelco.com
55 S. Denton Avenue, New Hyde Park, NY 11040

SOLDERLESS TERMINALS



i-Clamp Insulation Displacement wire connectors provide a quick and secure method of connecting wires and devices. The i-Clamps easily pierces the wire insulation to make a tamper proof and reliable connection without the need to cut, strip or otherwise secure the wires. Without having to strip or prepare the wires, installations time is dramatically reduced while connection security is enhanced. i-Clamps are made from translucent Polycarbonate which makes these devices durable in shock and vibration environments as well as provide the ability to visually inspect the connections. Once secured, the connection is permanent and tamper proof without the need to worry about wire exposure or nuts and tape falling off over time.

Specifications:

- Housing:** Polycarbonate, UL 94V-0
- Contact/Jumper:** High Performance Copper Alloy, Nickel Plate
- UL Listed:** E490622/E490623
- Voltage Rating:** 277 VAC

Note: Product suitability to your application must be determined prior to use. All appropriate electrical codes should be followed.



One-Way Series

For Splicing Lines



Quick/easy splice for up to four lines

CAT. NO.	# OF WIRE RUNS/TAPS	WIRE RANGE (IN/OUT)	COLOR CODE	CURRENT RATING
8370	2 Wires	#14 AWG	Yellow	20 Amps @ 277 VAC
8371	3 Wires			
8372	4 Wires			
8373	4 wire, 2 circuit	#14 AWG	Yellow/Blue	20 Amps @ 277 VAC
8374	2 Wires	#14-12 AWG	Orange	20 Amps @ 277 VAC
8375	3 Wires			
8377	4 Wires			

GROUND (INPUT/OUTPUT)



HOT (INPUT/OUTPUT)



NEUTRAL (INPUT/OUTPUT)

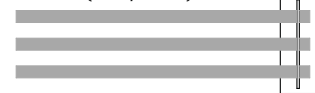

Two-Way Series

For Adding Fixtures or Components



- Dual wire clamp allows for i-Clamp to be preassembled onto fixture at factory. Splice can be completed on site
- Pre-assembly eliminates risk of i-Clamp being lost during fixture insulation

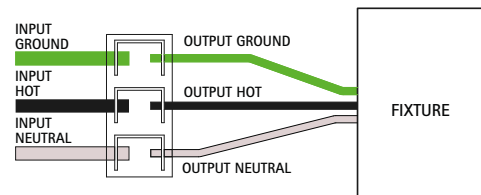

CAT. NO.	# OF WIRE RUNS/TAPS	WIRE RANGE (IN/OUT)	COLOR CODE	CURRENT RATING
8360	1 Wire	#16-14 AWG (In) / #16-14 AWG (Out)	Yellow	10 Amps @ 277 VAC
8361	2 Wires	#18 AWG (In) / #18 AWG (Out)	Blue	10 Amps @ 277 VAC
8362	2 Wires	#14 AWG (In) / #20-18 AWG (Out)	Yellow / Blue	5 Amps @ 277 VAC
8363	3 Wires	#14 AWG (In) / #20-18 AWG (Out)	Yellow / Blue	5 Amps @ 277 VAC

T-Series

For Branching a Wire

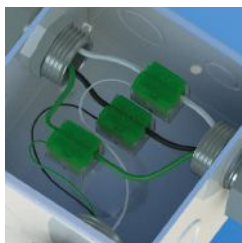

i-Clamp hinges open to allow main wire to be ran thru connector without any cuts or stripping

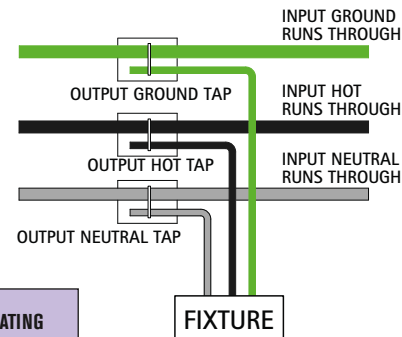

CAT. NO.	# OF WIRE RUNS/TAPS	WIRE RANGE (IN/OUT)	COLOR CODE	CURRENT RATING
8380	1 Run / 1 Tap	#14 AWG (In) / #16 AWG (Out)	Green	15 Amps @ 277 VAC
8381	1 Run / 1 Tap	#12-10 AWG (In) / #16-14 AWG (Out)	Yellow	15 Amps @ 277 VAC
8382	1 Run / 1 Tap	#12-10 AWG (In) / #14-12 AWG (Out)	Orange	20 Amps @ 277 VAC
8383	1 Run / 1 Tap	#16-14 AWG (In) / #22-18 AWG (Out)	Blue	5 Amps @ 277 VAC

SLIM-LINE PC SCREW TERMINALS

These easy to mount multi-purpose screw terminals are a practical low cost alternative to PC edge connectors. Will accept solid & stranded wire or wire crimp terminals. Supplied unassembled or with screw installed and captivated. These screw terminals have the same mounting hole pattern as quick fit terminals which allows instant change between quick fit and screw terminals.

Features:

- Same mounting hole pattern as most quick fit terminals
- Color coded screws available for quick identification
- Stable no rock design
- Accepts #14-22 AWG solid or stranded wire, crimp terminals or lugs
- Ideally suited for high density packaging
- Easy accessible for PC board assembly and troubleshooting

HEAD COLOR	SUFFIX
RED	-2
BLACK	-3
WHITE	-4
BLUE	-5
GREEN	-6
YELLOW	-7
NICKEL	none

COLOR SELECTION:
Select desired screw terminal and add color suffix to the screw terminal Cat. No.

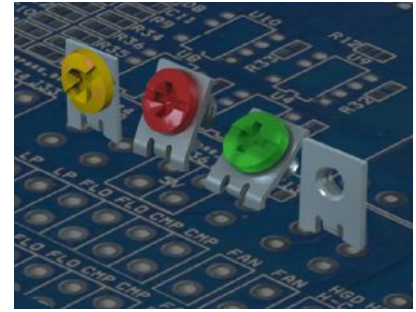

90° Angle

Specifications:

Current Rating: 15 Amps
Terminal: Brass, Matte Tin Plate
Binding Head Screw: Brass, Nickel Plate

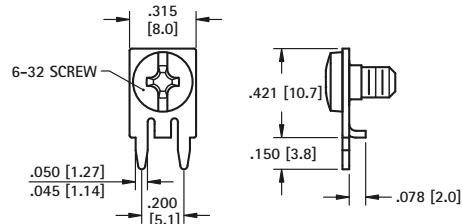

Mounting Detail

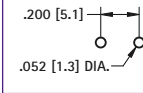

Color coded screws available (add color screw suffix to Cat No.)

CAT. NO. 7837 (No Screw Supplied)

CAT. NO. 8183 (Screw Supplied Unassembled)

CAT. NO. 7757 (Screw Installed & Captivated)

60° Angle

Specifications:

Current Rating: 15 Amps
Terminal: Brass, Matte Tin Plate
Binding Head Screw: Brass, Nickel Plate

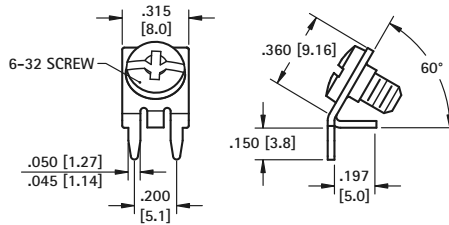

Mounting Detail

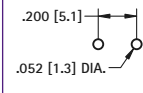

Color coded screws available (add color screw suffix to Cat No.)

CAT. NO. 7838 (No Screw Supplied)

CAT. NO. 8184 (Screw Supplied Unassembled)

CAT. NO. 7758 (Screw Installed & Captivated)

45° Angle

Specifications:

Current Rating: 15 Amps
Terminal: Brass, Matte Tin Plate
Binding Head Screw: Brass, Nickel Plate

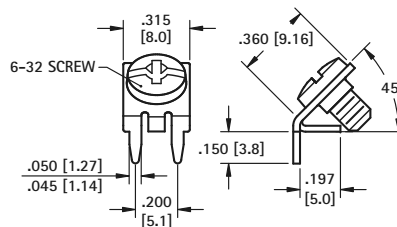

Mounting Detail

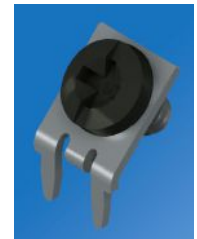
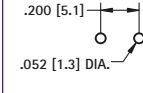

Color coded screws available (add color screw suffix to Cat No.)

CAT. NO. 7839 (No Screw Supplied)

CAT. NO. 8185 (Screw Supplied Unassembled)

CAT. NO. 7759 (Screw Installed & Captivated)

BINDING HEAD SCREWS – COLORED HEAD

M4 × 6.3mm L	M3 × 6mm L	HEAD COLOR	6-32 × .250 (6.3) L
CAT. NO.	CAT. NO.		CAT. NO.
7799-1	7689-1	NICKEL	8190-1
9192-2	9191-2	RED	9190-2
9192-3	9191-3	BLACK	9190-3
9192-4	9191-4	WHITE	9190-4
9192-5	9191-5	BLUE	9190-5
9192-6	9191-6	GREEN	9190-6
9192-7	9191-7	YELLOW	9190-7

Ideal for quick identification of screw terminal. Reduces errors in wiring of cables. See pages 73-77 for screw terminals with colored screws installed. Only head is painted, provides reliable electrical contact to terminal.

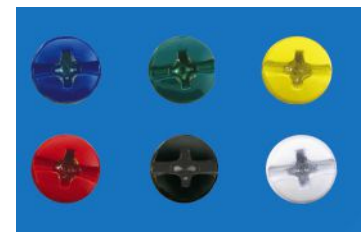
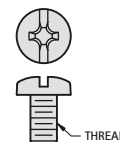

MATERIAL: Brass, Nickel Plate with Painted Color Head

PC SCREW TERMINALS

These easy-to-mount, multipurpose screw type terminals are a practical, low-cost alternative to PC screw type edge connectors, barrier blocks, terminal boards and terminal strips. Steadfast and easy to install, will accommodate solid or stranded wire, crimp type terminals or lugs. Multi-placement of these low-profile terminals make them ideally suited for high density packaging. Supplied unassembled or with screw installed and captivated.

PRINCIPAL FEATURES

- Low profile
- Stable, no-rock design with exclusive anti-rotational feature
- Easily mounts with four legs into pre-drilled or punched holes
- Accepts #14-22 AWG solid or stranded wire, crimp type terminals or lugs
- Ideally suited for high-density packaging
- Available in horizontal or vertical mounting
- Space-saving and time saving
- Easy accessibility for PC board testing
- Binding screw is positioned above board level to avoid wicking during wave soldering
- Terminals are made of Brass with Tin Plate
- Supplied with a combination drive 6-32 binding head screw

CAT. NO. COLOR SUFFIX
Ex: XXXX -X

COLOR SELECTION:
Select desired screw terminal and add color suffix to the screw terminal Cat. No.

HEAD COLOR	SUFFIX
RED	-2
BLACK	-3
WHITE	-4
BLUE	-5
GREEN	-6
YELLOW	-7
NICKEL	none

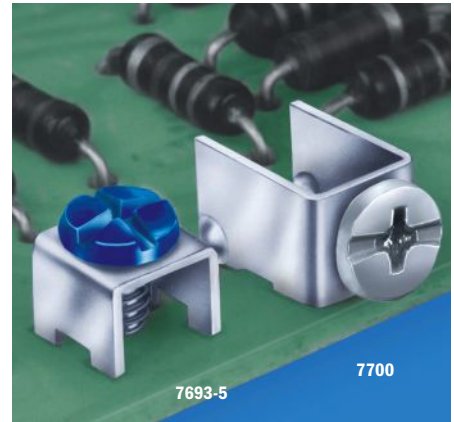

SNAP-IN PC MOUNT

- Color coded screws available (add color screw suffix to Cat. No.)

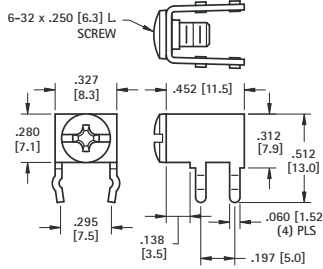

HORIZONTAL TYPE

SPECIFICATIONS

Rated: 15 Amps
Terminal: .032 (.81) Brass, Matte Tin Plate
Binding Head Screw: Brass, Nickel Plate

Mounting Detail

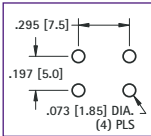

Color coded screws available (add color screw suffix to Cat. No.)

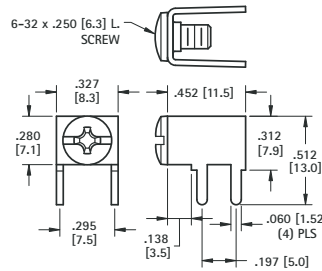

PC MOUNT

- Color coded screws available (add color screw suffix to Cat. No.)

CAT. NO. 7779 (No Screw Supplied)

CAT. NO. 7690 (Screw Supplied Unassembled)

CAT. NO. 7692 (Screw Installed & Captivated)

CAT. NO. 7781 (No Screw Supplied)

CAT. NO. 8190 (Screw Supplied Unassembled)

CAT. NO. 7700 (Screw Installed & Captivated)



SNAP-IN PC MOUNT

- Color coded screws available (add color screw suffix to Cat. No.)

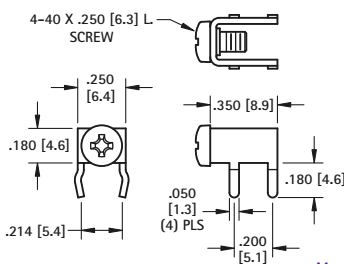

SPECIFICATIONS

Rated: 15 Amps
Terminal: .032 (.81) Brass, Matte Tin Plate
Binding Head Screw: Brass, Nickel Plate

Mounting Detail

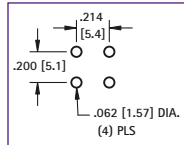

45°

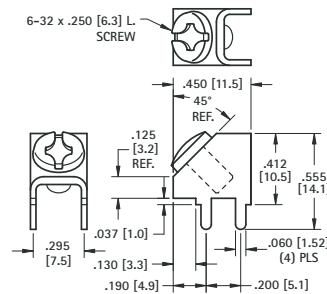

PC MOUNT

- Color coded screws available (add color screw suffix to Cat. No.)

Mounting Detail

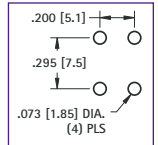

CAT. NO. 7774 (No Screw Supplied)

CAT. NO. 7773 (Screw Supplied Unassembled)

CAT. NO. 7783 (No Screw Supplied)

CAT. NO. 8189 (Screw Supplied Unassembled)

CAT. NO. 7702 (Screw Installed & Captivated)



SNAP-IN PC MOUNT

- Color coded screws available (add color screw suffix to Cat. No.)

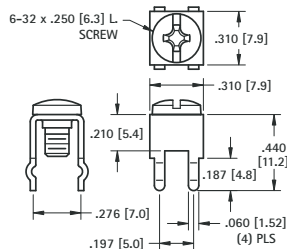

VERTICAL TYPE

SPECIFICATIONS

Rated: 15 Amps
Terminal: .032 (.81) Brass, Matte Tin Plate
Binding Head Screw: Brass, Nickel Plate

Mounting Detail

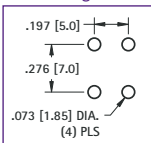

Color coded screws available (add color screw suffix to Cat. No.)

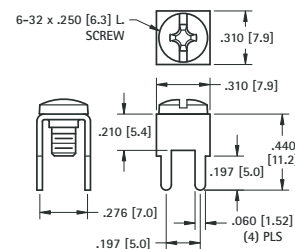

PC MOUNT

- Color coded screws available (add color screw suffix to Cat. No.)

CAT. NO. 7780 (No Screw Supplied)

CAT. NO. 7691 (Screw Supplied Unassembled)

CAT. NO. 7693 (Screw Installed & Captivated)

CAT. NO. 7782 (No Screw Supplied)

CAT. NO. 8191 (Screw Supplied Unassembled)

CAT. NO. 7701 (Screw Installed & Captivated)

PC SCREW TERMINALS

LOW PROFILE VERTICAL TYPE

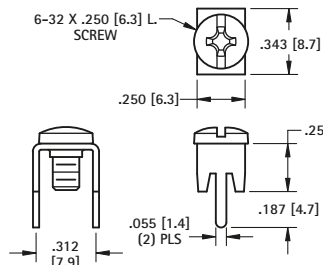

SPECIFICATIONS

Rated: 15 Amps
Terminal: .032 (.81) Brass, Matte Tin Plate
Binding Head Screw: Brass, Nickel Plate

Mounting Detail

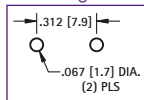

CAT. NO. 7784 (No Screw Supplied)

CAT. NO. 8198 (Screw Supplied Unassembled)

CAT. NO. 7778 (Screw Installed & Captivated)

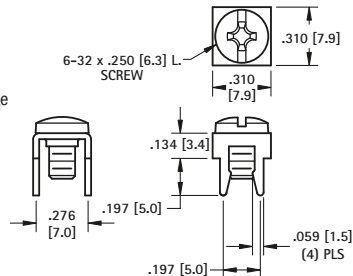

CAT. NO. 7785 (No Screw Supplied)

CAT. NO. 8195 (Screw Supplied Unassembled)

CAT. NO. 7775 (Screw Installed & Captivated)

• Color coded screws available (add color screw suffix to Cat. No.)
Mounting Detail

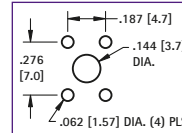

VERTICAL TYPE



EXTENDED

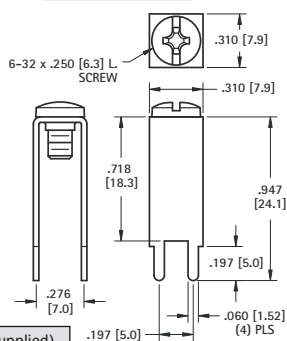

SPECIFICATIONS

Rated: 15 Amps
Terminal: .032 (.81) Brass, Matte Tin Plate
Binding Head Screw: Brass, Nickel Plate

Mounting Detail

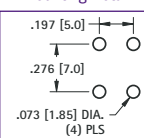

CAT. NO. 7789 (No Screw Supplied)

CAT. NO. 7697 (Screw Supplied Unassembled)

CAT. NO. 7699 (Screw Installed & Captivated)

HEAVY DUTY

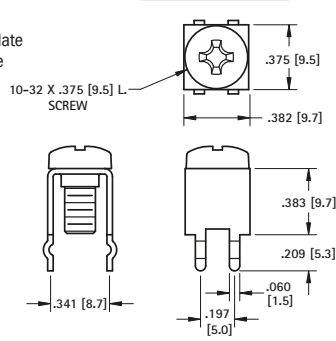

CAT. NO. 7791 (No Screw Supplied)

CAT. NO. 8174 (Screw Supplied Unassembled)



Mounting Detail

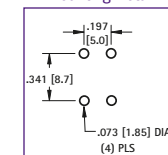

30 AMP - HEAVY DUTY



HORIZONTAL

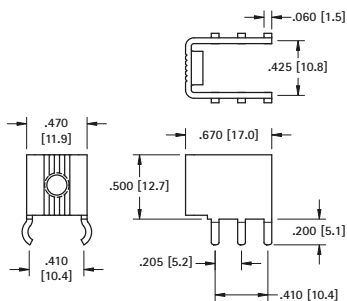

SPECIFICATIONS

Rated: 30 Amps
Terminal: .045 (1.14) Brass, Matte Tin Plate
Screw: Stainless Steel

Mounting Detail

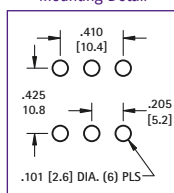

CAT. NO. 7801 (No Screw Supplied)

CAT. NO. 8166 (Screw Supplied Unassembled)

VERTICAL

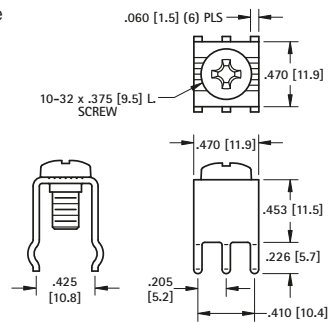

CAT. NO. 7787 (No Screw Supplied)

CAT. NO. 8196 (Screw Supplied Unassembled)



30 AMP

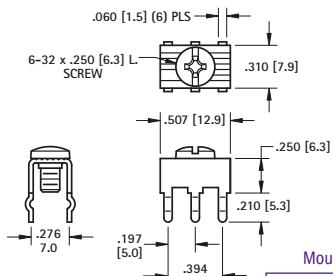

Mounting Detail

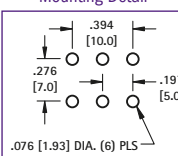

SPECIFICATIONS

Rated: 30 Amps
Terminal: .032 (.81) Brass, Matte Tin Plate
Binding Head Screw: Brass, Nickel Plate

CAT. NO. 7786 (No Screw Supplied)

CAT. NO. 8197 (Screw Supplied Unassembled)

CAT. NO. 8199 (Screw Installed & Captivated)

COLOR CODED GUIDE

CAT. NO. COLOR SUFFIX
Ex: XXXX -X

COLOR SELECTION:
 Select desired screw terminal and add color suffix to the screw terminal Cat. No.

HEAD COLOR	SUFFIX
RED	-2
BLACK	-3
WHITE	-4
BLUE	-5
GREEN	-6
YELLOW	-7
NICKEL	none

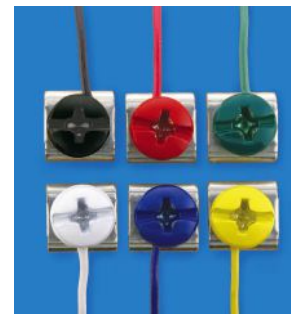

Refer to page 69 for color screws only

SEMS SCREW TERMINALS

SPECIFICATIONS

Terminal: .032 (.81) Brass, Matte Tin Plate
Screw & Washer: Steel, Nickel Plate

SEMS Screw Terminals provide quick and secure attachment of wire leads. SEMS screw has captivated, free spining lock washer, eliminated twisting of wire when tightening lead to terminal. Washer will rise with head of screw when unscrewed.

15 AMP

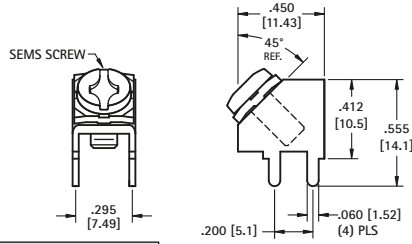
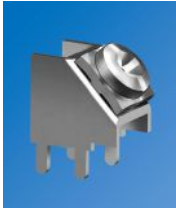

CAT. NO. 8189-SEMS (Screw Supplied Unassembled)

CAT. NO. 7702-SEMS (Screw Installed & Captivated)

SEMS SCREW ONLY

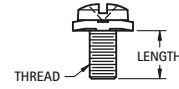
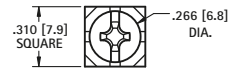

CAT. NO.	THREAD	LENGTH
9920	6-32	.250 (6.4)
9923	M3	.188 (4.8)

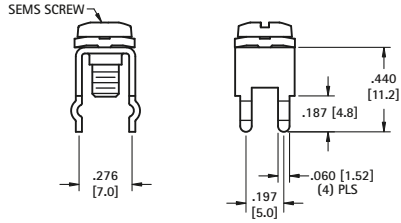

6-32 THREAD

CAT. NO.	
7681-SEMS	Screw Supplied Unassembled
7693-SEMS	No Screw Supplied

M3 THREAD

CAT. NO.	
7698-SEMS	Screw Supplied Unassembled
7696-SEMS	No Screw Supplied

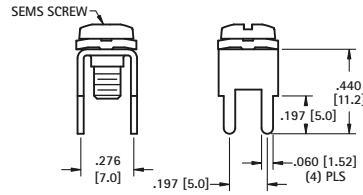

6-32 THREAD

CAT. NO.	
8191-SEMS	Screw Supplied Unassembled
7701-SEMS	No Screw Supplied

M3 THREAD

CAT. NO.	
7771-SEMS	Screw Supplied Unassembled
7772-SEMS	No Screw Supplied

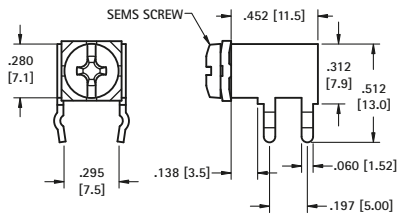

6-32 THREAD

CAT. NO.	
7690-SEMS	Screw Supplied Unassembled
7692-SEMS	Screw Installed & Captivated

M3 THREAD

CAT. NO.	
7699-SEMS	Screw Supplied Unassembled
7695-SEMS	No Screw Supplied

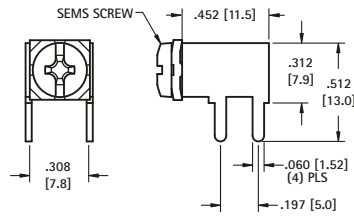

6-32 THREAD

CAT. NO.	
8190-SEMS	Screw Supplied Unassembled
7700-SEMS	No Screw Supplied

M3 THREAD

CAT. NO.	
7761-SEMS	Screw Supplied Unassembled
7762-SEMS	No Screw Supplied

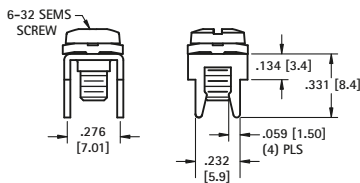

CAT. NO. 8195-SEMS (Screw Supplied Unassembled)

CAT. NO. 7775-SEMS (Screw Installed & Captivated)

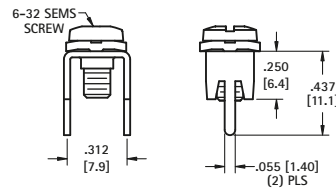

CAT. NO. 8198-SEMS (Screw Supplied Unassembled)

CAT. NO. 7778-SEMS (Screw Installed & Captivated)



PC MOUNT

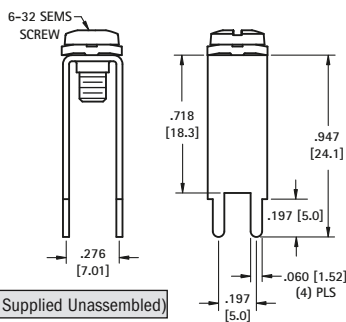

CAT. NO. 7697-SEMS (Screw Supplied Unassembled)

CAT. NO. 7699-SEMS (Screw Installed & Captivated)

30 AMP

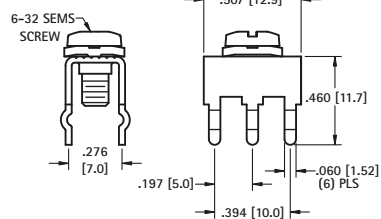

CAT. NO. 8197-SEMS (Screw Supplied Unassembled)

CAT. NO. 8199-SEMS (Screw Installed & Captivated)



METRIC PC SCREW TERMINALS

These easy-to-mount, multipurpose screw type terminals are a practical, low-cost alternative to PC screw type edge connectors, barrier blocks, terminal boards and terminal strips. Steadfast and easy to install, will accommo-

date solid or stranded wire, crimp type terminals or lugs. Multi- placement of these low-profile terminals make them ideally suited for high density packaging. Supplied unassembled or with screw installed and captivated.

PRINCIPAL FEATURES

- Stable, no-rock design with exclusive anti-rotational feature
- Easily mounts with four legs into pre-drilled or punched holes
- Accepts #14-22 AWG solid or stranded wire, crimp type terminals or lugs
- Ideally suited for high-density packaging
- Easy accessibility for PC board testing
- Binding screw is positioned above board level to avoid wicking during wave soldering
- All dimensions appear in millimeters

HEAD COLOR	SUFFIX
RED	-2
BLACK	-3
WHITE	-4
BLUE	-5
GREEN	-6
YELLOW	-7
NICKEL	none

COLOR SELECTION:
Select desired screw terminal and add color suffix to the screw terminal Cat. No.

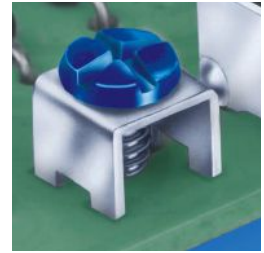

Refer to page 69 for color screws only

HORIZONTAL TYPE



7695-2
SNAP-IN PC MOUNT

- Color coded screws available (add color screw suffix to Cat. No.)

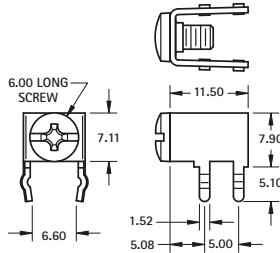

SPECIFICATIONS

Rated: 15 Amps
Terminal: .81 Brass, Matte Tin Plate
Screw: Brass, Nickel Plate

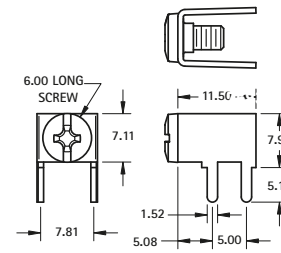

7762-3
PC MOUNT

- Color coded screws available (add color screw suffix to Cat. No.)

Mounting Detail

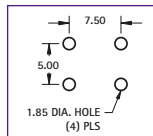

M3 THREAD CAT. NO.	No Screw Supplied	M4 THREAD CAT. NO.
7790	No Screw Supplied	7792
7689	Screw Supplied Unassembled	7793
7695	Screw Installed & Captivated	7794

M3 THREAD CAT. NO.	No Screw Supplied	M4 THREAD CAT. NO.
7760	No Screw Supplied	7764
7761	Screw Supplied Unassembled	7765
7762	Screw Installed & Captivated	7766

VERTICAL TYPE



7696-4
SNAP-IN PC MOUNT

- Color coded screws available (add color screw suffix to Cat. No.)

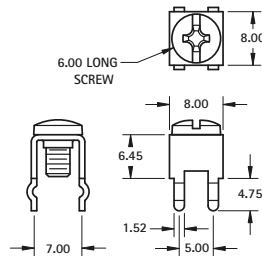

SPECIFICATIONS

Rated: 15 Amps
Terminal: .81 Brass, Matte Tin Plate
Screw: Brass, Nickel Plate

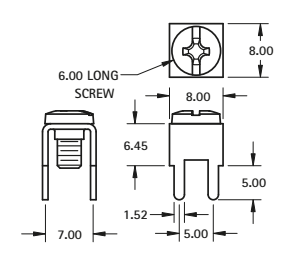

7772-6
PC MOUNT

- Color coded screws available (add color screw suffix to Cat. No.)

Mounting Detail

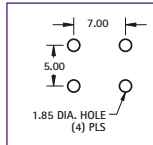

M3 THREAD CAT. NO.	No Screw Supplied	M4 THREAD CAT. NO.
7788	No Screw Supplied	7795
7698	Screw Supplied Unassembled	7796
7696	Screw Installed & Captivated	7797

M3 THREAD CAT. NO.	No Screw Supplied	M4 THREAD CAT. NO.
7770	No Screw Supplied	7767
7771	Screw Supplied Unassembled	7768
7772	Screw Installed & Captivated	7769

30 AMP - VERTICAL TYPE



7800
SNAP-IN PC MOUNT

- Color coded screws available (add color screw suffix to Cat. No.)

SPECIFICATIONS

Rated: 30 Amps
Terminal: .81 Brass, Matte Tin Plate
Screw: Brass, Nickel Plate

CAT. NO.	No Screw Supplied
7798	No Screw Supplied
7799	Screw Supplied Unassembled
7800	Screw Installed & Captivated

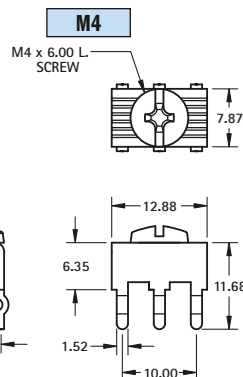

PRINCIPAL FEATURES

- Compact, heavy duty design
- Six snap-in legs for total stability
- Serrated top surface secures connection

Mounting Detail

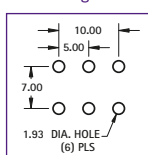

M5

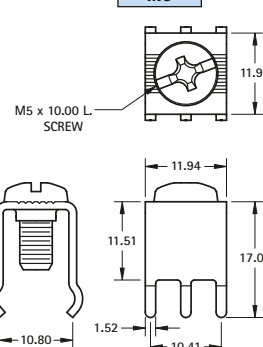

7808
SNAP-IN PC MOUNT

SPECIFICATIONS

Rated: 30 Amps
Terminal: 1.14 Brass, Matte Tin Plate
Screw: Brass, Nickel Plate

CAT. NO.	No Screw Supplied
7807	No Screw Supplied
7808	Screw Supplied Unassembled

Mounting Detail

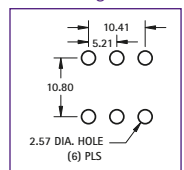

MINI BINDING POSTS



THRU HOLE

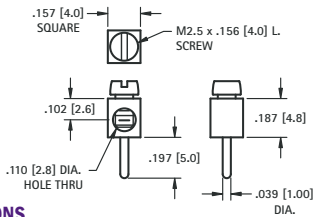

SPECIFICATIONS

Terminal: Brass, Tin Plate
Screw: Steel, Zinc Plate
Mounting Hole: .047 (1.2)
Current Rating: 15 AMP

CAT. NO. 8730 (Screw Installed)



HORIZONTAL

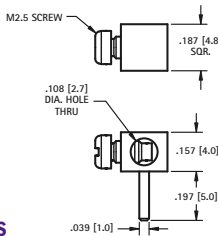

SPECIFICATIONS

Terminal: Brass, Tin Plate
Screw: Steel, Zinc Plate
Mounting Hole: .047 (1.2)
Current Rating: 15 AMP

CAT. NO. 8734 (Screw Installed)

WIRE CONTACT

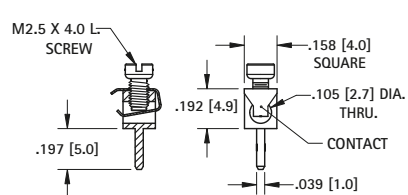

SPECIFICATIONS

Terminal: Brass, Tin Plate
Screw: Steel, Zinc Plate
Contact: Phosphor Bronze, Tin Plate
Mounting Hole: .047 (1.2)
Current Rating: 15 AMP

CAT. NO. 8737 (Screw Installed)

LOW PROFILE SCREW TERMINALS



6-32

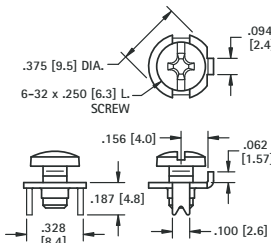

SPECIFICATIONS

Rated: 15 Amps
Terminal: .032 (.81) Brass, Matte Tin Plate
Screw: Stainless Steel

CAT. NO. 1284 (No Screw Supplied)

CAT. NO. 1298 (Screw Supplied Unassembled)

CAT. NO. 1201 (Screw Installed & Captivated)

Mounting Detail

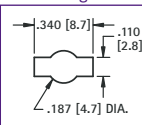

These sturdy, low cost screw terminals, feature an anti-rotation tab for use with spade terminals. They are available with the screw installed and captivated, the screw unassembled or without a screw.

PRINCIPLE FEATURES

- Easy to connect using solid or stranded wire, crimp lugs or terminals
- Anti-rotation tab for use with spade terminals
- Supplied with screw installed and captivated, with screw unassembled, or without screw
- Stainless Steel screw will not wick



8-32

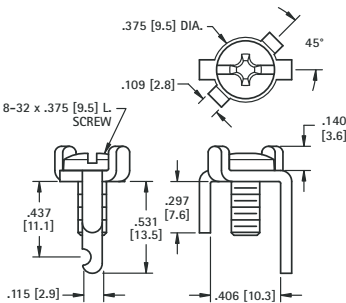

SPECIFICATIONS

Rated: 15 Amps
Terminal: .064 (1.6) Brass, Matte Tin Plate
Screw: Brass, Nickel Plate

CAT. NO. 1205 (No Screw Supplied)

CAT. NO. 1207 (Screw Supplied Unassembled)

CAT. NO. 1209 (Screw Installed)

Mounting Detail

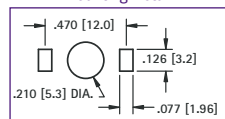

HEAVY DUTY SCREW TERMINALS - 30 AMP

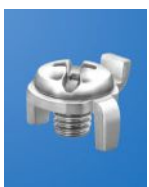

10-32

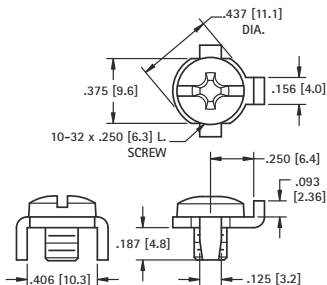

SPECIFICATIONS

Rated: 30 Amps
Terminal: .062 (1.6) Brass, Matte Tin Plate
Screw: Stainless Steel

CAT. NO. 1293 (No Screw Supplied)

CAT. NO. 1299 (Screw Supplied Unassembled)

CAT. NO. 1202 (Screw Installed & Captivated)

Mounting Detail

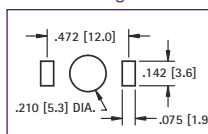

These heavy duty terminals are available with the screw installed or unassembled, and feature easy access to connect solid or stranded wire, crimp type lugs or terminals.

PRINCIPLE FEATURES

- Anti-rotation tab for use with spade terminals
- Below the board notched leg, to facilitate mechanical and solder connections
- Easy to connect using solid or stranded wire, crimp lugs or terminals
- Available with screw installed, unassembled, or without screw



10-32

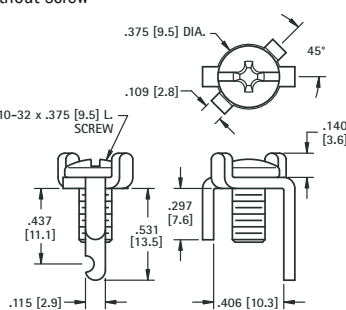

SPECIFICATIONS

Rated: 30 Amps
Terminal: .064 (1.6) Brass, Matte Tin Plate
Screw: Steel, Nickel Plate

CAT. NO. 1206 (No Screw Supplied)

CAT. NO. 1208 (Screw Supplied Unassembled)

CAT. NO. 1283 (Screw Installed)

Mounting Detail

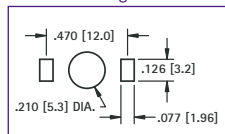

SCREW TERMINALS

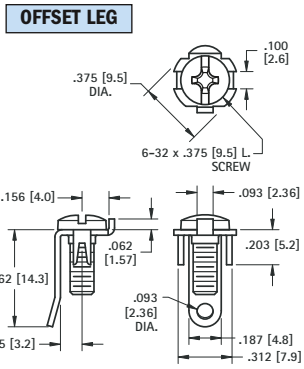

SPECIFICATIONS
Terminal: .032 (.81) Steel, Tin Plate
Screw: Steel, Nickel Plate
 (Screw Installed & Captivated)
Rated: 15 Amps

CAT. NO. 1248

STRAIGHT LEG

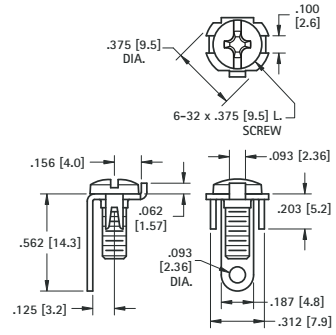
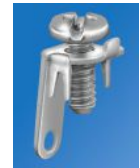

SPECIFICATIONS
Terminal: .032 (.81) Steel, Tin Plate
Screw: Steel, Nickel Plate
 (Screw Installed & Captivated)
Rated: 15 Amps

CAT. NO. 1215

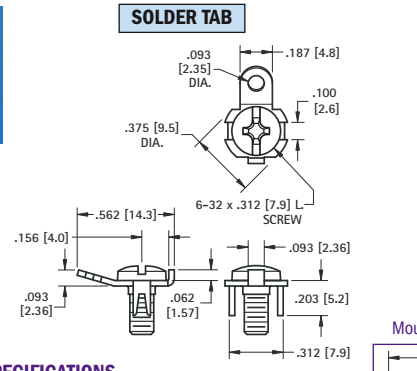
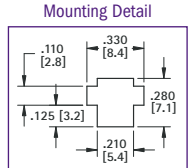

SPECIFICATIONS
Terminal: .032 (.81) Steel, Tin Plate
Screw: Steel, Nickel Plate
 (Screw Installed & Captivated)
Rated: 15 Amps

CAT. NO. 1232

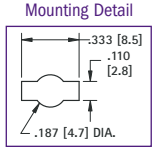

QUICK FIT

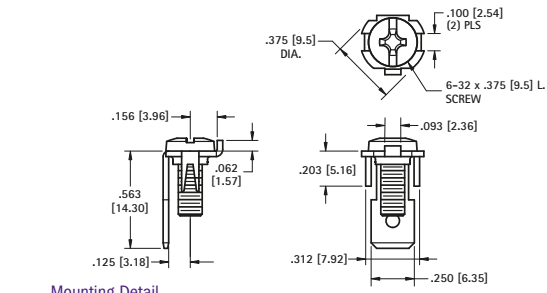

SPECIFICATIONS
Terminal: .032 (.81) Brass, Tin Plate
Screw: Steel, Nickel Plate
 (Screw Installed & Captivated)
Rated: 15 Amps

CAT. NO. 1217

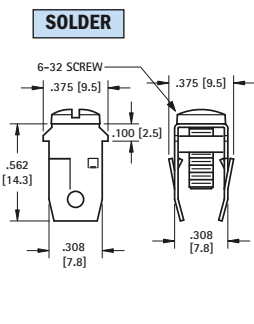
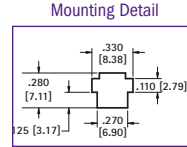

SPECIFICATIONS
Terminal: .020 (.51) Steel, Tin Plate
Screw: Steel, Zinc Plate,
 (Screw Installed & Captivated)
Rated: 15 Amps

CAT. NO. 1272

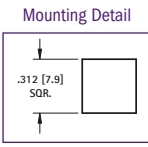

QUICK-FIT

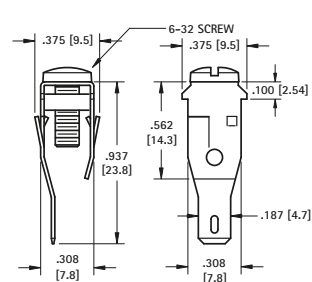

SPECIFICATIONS
Terminal: .020 (.51) Steel, Tin Plate
Screw: Steel, Zinc Plate,
 (Screw Installed & Captivated)
Rated: 15 Amps

CAT. NO. 1273

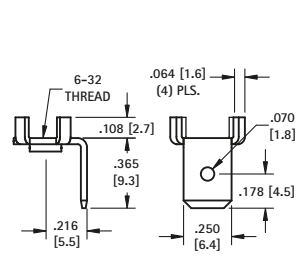

Mounting Detail

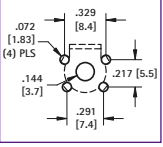

SPECIFICATIONS
Material: .032 (.81) Brass, Nickel Plate
Rated: 15 Amps

CAT. NO. 1247 (No Screw Supplied)

CAT. NO. 1251 (Screw Supplied)



Supplied Unassembled

BINDING POST TERMINALS (RIVET TYPE)

SPECIFICATIONS Terminal: Brass, Tin Plate **Screw:** Steel, Zinc Plate (Screw Supplied Unassembled)

4-40

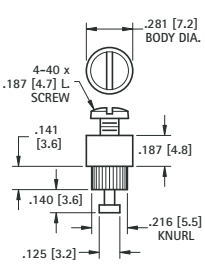

Mounting Hole: .220 (5.6)

CAT. NO. 1537

FOR .093 (2.38) BOARD

6-32

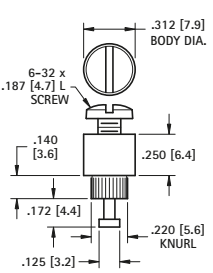

Mounting Hole: .225 (5.7)

CAT. NO. 1535

FOR .093 (2.38) BOARD

8-32

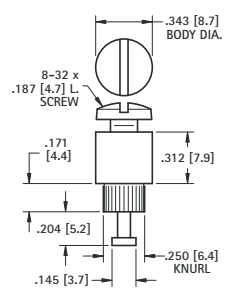

Mounting Hole: .255 (6.5)

CAT. NO. 1536

FOR .125 (3.2) BOARD



PC TERMINAL LUGS

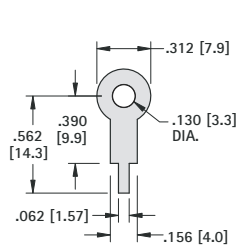

MATERIAL: .016 (.41) Brass, Tin Plate

CAT. NO. 680

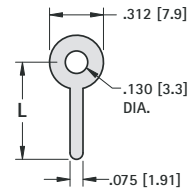

MATERIAL: .020 (.51) Brass, Tin Plate

CAT. NO.	L
4000	.500 (12.7)
4001	.562 (14.3)
4002	.750 (19.1)
4003	1.000 (25.4)

LOCKWASHER TERMINAL LUGS

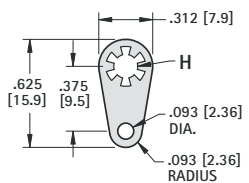

MATERIAL: .018 (.46) Brass, Tin Plate

CAT. NO.	H	STUD SIZE
908	.120 (3.1)	#4
914	.140 (3.6)	#6
915	.171 (4.3)	#8

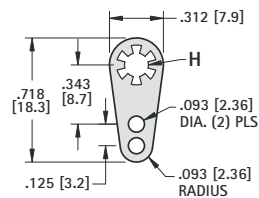

MATERIAL: .018 (.46) Brass, Tin Plate

CAT. NO.	H	STUD SIZE
910	.120 (3.1)	#4
918	.140 (3.6)	#6
906	.171 (4.3)	#8

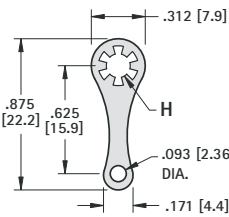

MATERIAL: .018 (.46) Brass, Tin Plate

CAT. NO.	H	STUD SIZE
903	.120 (3.1)	#4
904	.140 (3.6)	#6
905	.171 (4.3)	#8
913	.196 (5.0)	#10

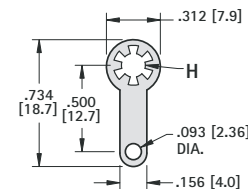

MATERIAL: .018 (.46) Brass, Tin Plate

CAT. NO.	H	STUD SIZE
909	.120 (3.1)	#4
916	.140 (3.6)	#6
917	.171 (4.3)	#8

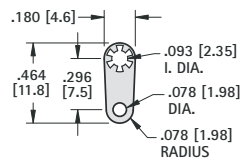

MATERIAL: .013 (.33) Brass, Tin Plate

CAT. NO. 907

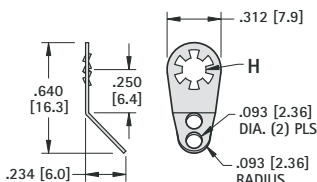

MATERIAL: .018 (.46) Brass, Tin Plate

CAT. NO.	H	STUD SIZE
7311	.120 (3.1)	#4
7312	.140 (3.6)	#6
7313	.171 (4.3)	#8

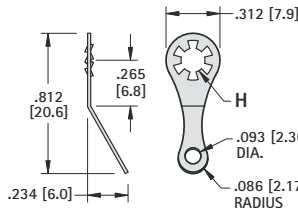

MATERIAL: .018 (.46) Brass, Tin Plate

CAT. NO.	H	STUD SIZE
7317	.120 (3.1)	#4
7318	.140 (3.6)	#6
7319	.171 (4.3)	#8
4704	.196 (5.0)	#10

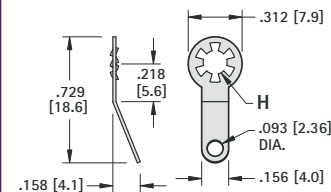

MATERIAL: .018 (.46) Brass, Tin Plate

CAT. NO.	H	STUD SIZE
7314	.120 (3.1)	#4
7315	.140 (3.6)	#6
7316	.171 (4.3)	#8

SOLDER TERMINAL LUGS

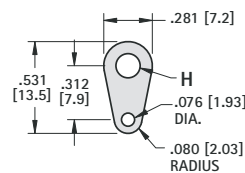

MATERIAL: .015 (.38) Brass, Tin Plate

CAT. NO.	H	STUD SIZE
7328	.120 (3.1)	#4
7329	.140 (3.6)	#6
7330	.171 (4.3)	#8

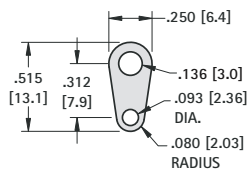

MATERIAL: .016 (.41) Brass, Tin Plate

CAT. NO. 4004

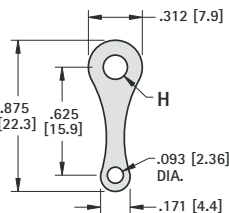

MATERIAL: .020 (.51) Brass, Tin Plate

CAT. NO.	H	STUD SIZE
7331	.120 (3.1)	#4
7332	.140 (3.6)	#6
7333	.171 (4.3)	#8
7310	.196 (5.0)	#10

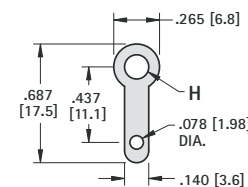

MATERIAL: .020 (.51) Brass, Tin Plate

CAT. NO.	H	STUD SIZE
7325	.120 (3.1)	#4
7326	.140 (3.6)	#6
7327	.171 (4.3)	#8
7340	.196 (5.0)	#10

DESIGNERS AND MANUFACTURERS

THINKKEYSTONE
ELECTRONICS CORP.

Terminals & Test Points

Certified Quality & Proven Performance
ISO 9001:2015 Quality System

www.keyelco.com

Access 3D Data Sheets
& Check Availability

View More

